

# VERSA BLOCK CLAMP

OWNER'S MANUAL

PRODUCT CODE: AVBC-1100



## PRODUCT OVERVIEW

The Versa Block Clamp is made for lifting and moving concrete blocks, rubber tyres, drums or other similar materials. The clamp consists of two sliding pads that can be adjusted to the desired widths and are locked by a cam locking on each side. The Versa Block Clamp is a multipurpose solution when fitted with different jaws to grab different material types, whether square or curved. These jaws can be easily changed and reversed to allow for picking up of objects from the inside face or inside out.



Dec. 2019

+84 274 371 2840 | [www.aardwolf.com.au](http://www.aardwolf.com.au) | [sales@aardwolf.com.au](mailto:sales@aardwolf.com.au)

# SPECIFICATIONS & FEATURES

## SPECIFICATIONS

GRIP RANGE (MM)	150 – 1100
WORKING LOAD LIMIT (KGS)	3000
NET WEIGHT (KGS)	161
GROSS WEIGHT(KGS)	175
PACKAGING DIMENSIONS (MM)	1500 X 570 X 360

## FEATURES

- Handles heavy loads with different capacities.
- Grips and releases loads automatically.
- Simple and easy adjustment of jaw widths.
- The rubber jaws protect loads from being damaged.
- Optional jaws for different material shapes.
- Lifting eye allows for easy hook attachment.

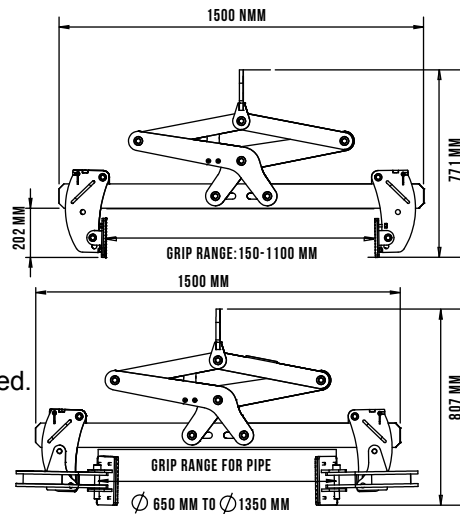

## PART DRAWING - PART LIST

### VERSA BLOCK CLAMP 1100

Code: AVBC1100

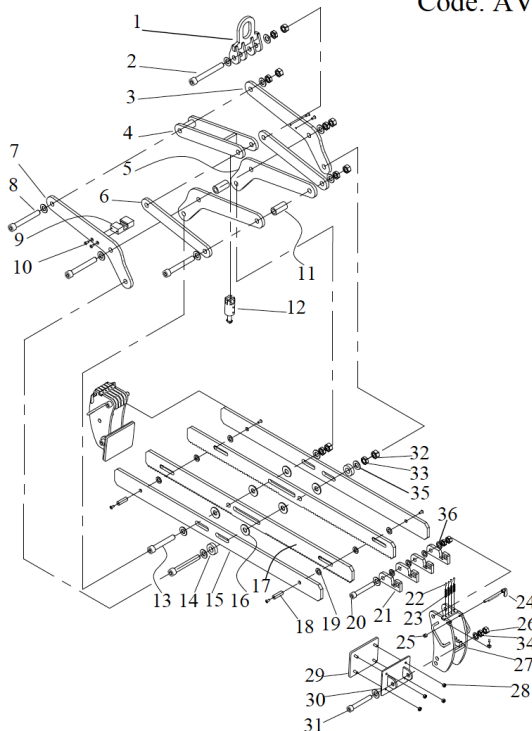

PART LIST			
CODE	POSITION	DESCRIPTION	QTY
AVBC 1100-1	1	Hook	1
AVBC 1100-2	2	Socket head cap screw M24x220	1
AVBC 1100-3	3	Lower arm-right	1
AVBC 1100-4	4	Upper arm-in	1
AVBC 1100-5	5	Lower arm-in	2
AVBC 1100-6	6	Upper arm-out	2
AVBC 1100-7	7	Lower arm-left	1
AVBC 1100-8	8	Socket head cap screw M24x200	4
AVBC 1100-9	9	Lock base	1
AVBC 1100-10	10	Socket countersunk screw M8x20	10
AVBC 1100-11	11	Bushing	2
AVBC 1100-12	12	AW lock	1
AVBC 1100-13	13	Socket head cap screw M24x160	1
AVBC 1100-14	14	Washing 60*25*17.5	2
AVBC 1100-15	15	Horizontal bar	2
AVBC 1100-16	16	Washing 60*25*4	6
AVBC 1100-17	17	Gear-run	2
AVBC 1100-18	18	Shaft 20	3
AVBC 1100-19	19	Washing 35*20*4	15
AVBC 1100-20	20	Socket head cap screw M20x140	2
AVBC 1100-21	21	Cam base	8
AVBC 1100-22	22	Socket head cap screw M8x10	8
AVBC 1100-23	23	Spring	8
AVBC 1100-24	24	Cam	4
AVBC 1100-25	25	Cam key	2
AVBC 1100-26	26	Nut M20	4
AVBC 1100-27	27	Clamp pad	8
AVBC 1100-28	28	Nut M8	2
AVBC 1100-29	29	Rubber base	2
AVBC 1100-30	30	Steel base	2
AVBC 1100-31	31	Socket head cap screw M20x160	2
AVBC 1100-32	32	Nut M24	6
AVBC 1100-33	33	Nut M24-thin	6
AVBC 1100-34	34	Nut M20-thin	4
AVBC 1100-35	35	Washing M24	12
AVBC 1100-36	36	Washing M20	8



# SAFETY INSTRUCTIONS

To ensure safety during operation, you must carefully read these instructions to avoid injury, death or damage while using the AVBC-1100:

- Determine whether the capacity of a crane hook or forklift boom is suitable for use with the clamp.
- Determine the capacity of crane hook or hoisting equipment that is suitable for the maximum load weight plus clamp weight.
- Perform a load test for the clamp before handling the load.
- Carefully read the clamp manual before operating.
- Only competent and authorised personnel should be allowed to operate the clamp.
- Follow the safety regulations stipulated by local authorities.
- Ensure that the manual is available during operation.
- Always wear appropriate protective equipment like helmet, gloves, safety boots etc.
- Always check clamps. If clamp is worn or damaged, DO NOT use.
- Make sure that the clamping jaw surfaces are clean.
- Make sure that there are no obstructions during the working process.
- The load must not exceed the maximum allowable weight specified.
- The load must be a single block with a smooth or rough and non-porous surface.
- Size of the load must be within the gripping range specified from the manufacturer.
- The grip depends on friction so do not lift wet blocks as lifting wet blocks may cause the rubber pads to lose their grip. It must be checked that the rubber pads are free from dirt and grease.
- Do a risk assessment of the material that is being lifted. The load must be free of fractures and other defects that may cause the load to fall apart while being lifted.
- Connections or individual parts of hoisting accessories should never be able to loosen by themselves.
- Defective hoisting accessories should never be used.
- To avoid injury, no one should be allowed to stand under the load.
- Do not carry out any lifting operations if any issues are found.
- Never operate a clamp that is damaged, malfunctioning or missing parts.
- Never operate a clamp if the tables for load capacity or any other warnings are missing, obscure or unclear.
- All inspections and tests must be carried out before lifting.

## INSTRUCTIONS FOR USE

- **Step 1:** Connect the Versa Block Clamp to a crane or hoisting equipment to start.
- **Step 2:** Move the clamp to the material being lifted.
- **Step 3:** Position of the clamp should be square with the block so that the load is balanced.
- **Step 4:** Rotate the cam locking in anti-clockwise direction to slide the sliding pads of both sides, after that rotating the cam locking in reverse direction to the first locked position.



# INSTRUCTIONS FOR USE

- **Step 5:** Adjust gripping range of the clamp so that it is suitable for size of block to picked up.
- **Step 6:** Lower the lifter onto the load and make sure that the block is inserted to full depth into the clamping jaws of the clamp.
- **Step 7:** Raise the hoist to allow the clamping jaws to close onto load. Then lift and move the block slowly to desired location.
- **Step 8:** Place it down and the locking latch on the left upper arm will automatically lock the clamp and raise the hoist to remove the clamp out of the material.

**NOTE:** The way to lift the block from the inside surface: Rotate the cam locking in anti-clockwise direction to slide the sliding pads out of the clamp and reverse these sliding pads to clamp the block from the inside face.

**CAUTION:** The clamp is only allowed to lift one load at one time.

**NOTE:** It is the responsibility of the user to adapt to state or local laws. The end user is responsible for using the equipment safely in the manner that it is designed for and within the rated capacity of the unit.

## INSPECTIONS & MAINTENANCE

It is important to establish a regular procedure for clamp inspection. Frequency of inspection will depend upon the amount of use the clamp receives. You may wish to maintain a written record, indicating inspection dates, condition of the clamp on each of those dates and any repairs made. Inspection records should be reviewed periodically. Always use original spare parts when carrying out repairs or maintenance.

## WARRANTY

At the time of delivery it is necessary to check that the lifter has not been damaged during shipment. Any claims must be presented within eight days of the date of delivery of the product.

We grant you 12 months warranty on the Versa Block Clamp, counted from the date of purchase.

The warranty will not be applicable if:

- The clamp is handled incorrectly during maneuvering.
- The operator fails to comply with the instructions in this manual.
- The clamp's maximum permissible capacity is exceeded.
- Damages are due to inadequate maintenance and inspections.
- Damage is due to improper storage.

### CONTACT US

📍 1B, An Phu, Thuan An, Binh Duong, Vietnam 📞 +84 274 371 2827438/39 📧 sales@aardwolf.com.vn 🌐 www.aardwolf.com.vn

