



# HANDY VACUUM LIFTER

## OWNER'S MANUAL

**PRODUCT CODE: AHVL500**



## CONTENTS

**SPECIFICATIONS & FEATURES ► SAFETY INSTRUCTIONS ► PARTS DRAWING & PART LIST**  
**INSTRUCTIONS FOR USE ► HOW TO CHANGE THE VACUUM PAD ► INSPECTIONS & MAINTENANCE**  
**► WARRANTY ►**

The AHVL500 is powered by a venturi vacuum generator, which needs a source of compressed air in order to function but requires no electricity. The vacuum generator has no moving parts and therefore no lubrication is required. This lifter consists of four (4) pads to make it can be replaced with different pads so that it fits with the sizes of materials.



SPECIFICATIONS:

Section \ Unit	METRIC	IMPERIAL
	mm-kgs	inch-lbs
Working load limit	520 x 125: 120	20.5" x 5": 265
	520 x 160: 180	20.5" x 6.3": 397
	520 x 220: 280	20.5" x 8.7": 617
	520 x 320: 500	20.5" x 12.6": 1102
Net weight	21	46
Gross weight	52	115
Packaging dimensions	570 x 350 x 290	22" x 13.7" x 11.4"

Battery information for alarm system	<ul style="list-style-type: none"><li>- Power supply: 3.7V Lipo battery</li><li>- Battery capacity: 2000mAh x 1</li><li>- Adapter: DC 5V-1A</li><li>- Standby time: 720 hours</li><li>- Charging cycle: 1000 times</li><li>- Charging time: 2 hours</li><li>- Non-stop working time: 7 hours</li><li>- 6-month warranty</li></ul>
Compressed air requirement	<ul style="list-style-type: none"><li>- Air consumption: 180 lifters/minute</li><li>- Supply air pressure: 5 bars</li></ul>

FEATURES

- Adjustable vacuum pads.
- Attach/release materials with an ON/OFF slide valve.
- Acoustic alarm system independently powered by a small 9V rechargeable battery.
- Vacuum gauge for a visual warning of low vacuum.



## BEFORE OPERATING THE LIFTER

- Attaching the lifter to hoisting equipment:
- Determine whether the capacity of the crane, hoist, sling and other attachments is suitable for combining with the Vacuum Lifter Handy and max. load weight as well.
- Perform a load test for the lifter before handling the load.

## SAFETY INSTRUCTIONS:

- Carefully read the user manual before operating.
- Ensure that the manual is available during operation.
- Always wear appropriate protective equipment.
- Avoid operating the lifter in rain.
- Make sure that the vacuum pad surface is clean and free from dirt and oil.
- Make sure that there is no obstructions during working process.
- Perform the test of load, vacuum pumping and warning light to ensure safety.
- The load must not exceed the maximum allowable weight specified.
- The load must be a single load with a smooth and non-porous surface.
- Always place the vacuum pad correctly and make sure it is balanced.
- The lifter is not allowed to lift and must stay clear of suspended load if the vacuum level is lower than 53 kPa (40 CmHg) and the red warning light is turned on.
- To avoid injury, no one is allowed to stand under the load.
- Do not carry out any lifting operations if any issue is found.
- Never lift a load when the vacuum indicator shows inadequate vacuum pressure.
- Never operate the lifter that is damaged, malfunctioning or missing parts.
- Never operate the lifter if the edges of the vacuum pad are cut or damaged.
- Never operate a lifter if the labels for load capacity or any other warnings are missing, obscure or unclear.
- Never lift a load over people.
- Never use the lifter in dangerous environments .
- All inspections and tests must be carried out before lifting.

**NOTE:** Aardwolf Industries LLC denies any claims due to failure of unexpected load release or human and/or material losses in event of employing non-original pads.

## HANDY VACUUM LIFTER Model: AHVL500 ASSEMBLY DIAGRAM

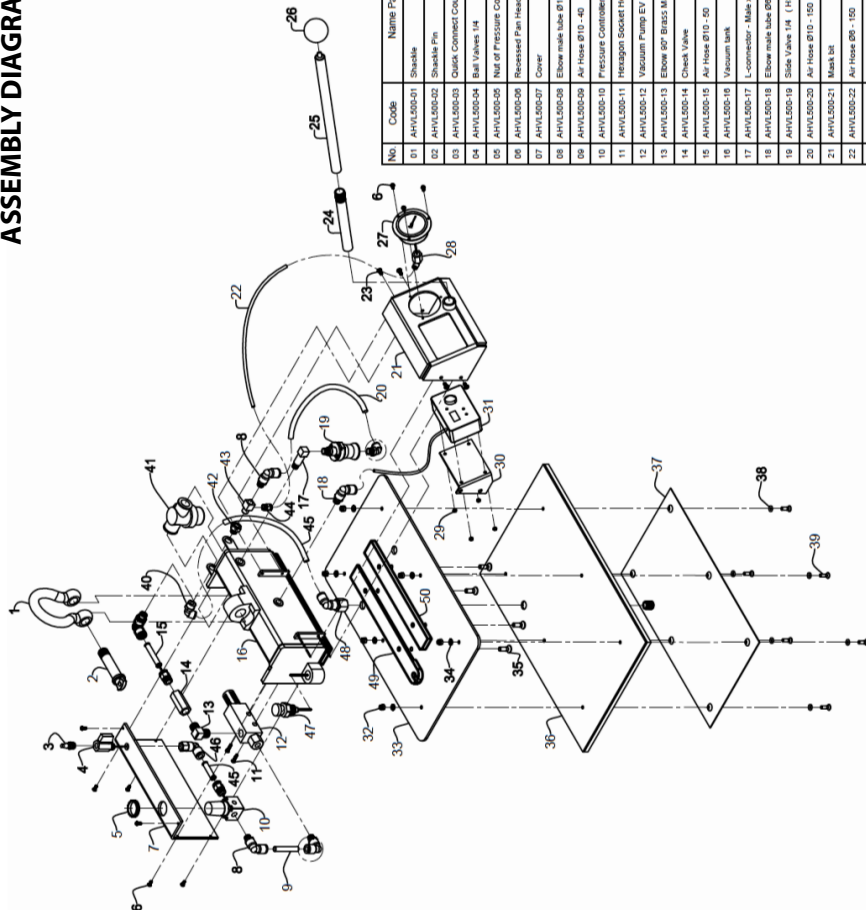

### PARTS LIST

No	Code	Name Part	Qty.	No	Code	Name Part	Qty.
01	AHVL500-01	Shackle	01	26	AHVL500-26	Rubber handle	01
02	AHVL500-02	Shackle Pin	01	27	AHVL500-27	Vacuum Gauge Male 1/4	01
03	AHVL500-03	Quick Connect Coupling	01	28	AHVL500-28	Elbow Female Tube Ø9 x 1/4	01
04	AHVL500-04	Ball Valves 1/4	01	29	AHVL500-29	Nut M4	04
05	AHVL500-05	Nut of Pressure Controller	01	30	AHVL500-30	Warning Horn Sound	01
06	AHVL500-06	Recessed Pin Head Screw - M4 x 10	06	31	AHVL500-31	Warning Horn	01
07	AHVL500-07	Cover	01	32	AHVL500-32	Nylon Nut M8	06
08	AHVL500-08	Elbow male tube Ø19 x 1/4	06	33	AHVL500-33	Vacuum Gauge	01
09	AHVL500-09	Air Hose Ø10 - 40	01	34	AHVL500-34	Washer Ø6	06
10	AHVL500-10	Pressure Controller	01	35	AHVL500-35	Countersunk Screw M8 x 30	04
11	AHVL500-11	Hexagon Socket Head Cap Screw M5x30	02	36	AHVL500-36	Vacuum Pad	01
12	AHVL500-12	Vacuum Pump EV - 20	01	37	AHVL500-37	Plate Limit	01
13	AHVL500-13	Elbow Ø9 Brass Male x Male 3/8	01	38	AHVL500-38	O Ring Seal	06
14	AHVL500-14	Check Valve	01	39	AHVL500-39	Countersunk Screw M8 x 20	06
15	AHVL500-15	Air Hose Ø10 - 50	01	40	AHVL500-40	Elbow Male Tube Ø10 x 3/8	01
16	AHVL500-16	Vacuum tank	01	41	AHVL500-41	Filter ZFB 10	01
17	AHVL500-17	L-connector - Male x Female 1/4	01	42	AHVL500-42	Bushes Reducing Brass 3/8 x 1/4	01
18	AHVL500-18	Elbow male tube Ø9 - 1/4	01	43	AHVL500-43	Two Brass 1 Male-2 Female, TubeØ1 1/4	01
19	AHVL500-19	Side Valve 1/4 (1/4xØ8)	01	44	AHVL500-44	Connector Male Tube Ø9 x 1/4	01
20	AHVL500-20	Air Hose Ø10 - 150	01	45	AHVL500-45	Air Hose Ø10 - 100	01
21	AHVL500-21	Mark 38	01	46	AHVL500-46	Elbow Female Tube Ø10 - 1/4	01
22	AHVL500-22	Air Hose Ø9 - 150	01	47	AHVL500-47	Loading Pad	01
23	AHVL500-23	Recessed Pin Head Screw - M5 x 10	04	48	AHVL500-48	Elbow Female Tube Ø10 - 3/8	01
24	AHVL500-24	Bottom handle	01	49	AHVL500-49	Slide Bar 1	01
25	AHVL500-25	Top handle	01	50	AHVL500-50	Slide Bar 2	01

- Step 1:** Connect the AHVL500 to a crane or other hoisting equipment to start.
- Step 2:** Carefully connect the air hose into the quick zone of lifter before lifting.
- Step 3:** Place the lifter in the center of the load for balancing to ensure safety during the lifting process.
- Step 4:** Turnload the slide valve to the ON position to supply the vacuum into the vacuum pad.
- Step 5:** Press the ON/OFF button of the alarm system and observe the vacuum level and when the alarm stops sound that means the vacuum is full and the lifter is ready to lift the load.
- Step 6:** Lift and move the load.
- Step 7:** When the load is placed down to the desired location, press the slide valve to the OFF position to stop the vacuum pumping and release the load.
- Step 8:** Carefully take disconnect the air hose to finish the lifting process.

## HOW TO CHANGE THE VACUUM PAD?

The Handy Vacuum Lifter (AHVL500) consists of a vacuum pad standard type is 520 mm x 320 mm: 500 kgs (1102 lbs) and the other optional vacuum pads with different the load capacities as below:

- 520 mm x 125 mm: 120 kgs (265 lbs)
- 520 mm x 160 mm: 180 kgs (397 lbs)
- 520 mm x 220 mm: 280 kgs (617 lbs)

How to change the vacuum pad? The operator can easily change the vacuum pad sizes depending on the handling needs. To determine the minimum length and width of the load as well as the maximum thickness of the load, please see these steps below:

- Step 1:** Turn off the lifter and disconnect the air hose out of the vacuum pad.
- Step 2:** Lift up the hand lockpad and slide the body in the left direction to release the lifter body out of the vacuum pad.
- Step 3:** The operator now can easily change the other vacuum pad size that is suitable for the load capacity.

**NOTE:** The manufacturer cannot be held responsible for any personal or material damage resulting from the use of non-original spare parts and unscheduled operations capable of modifying the safety requirements without the manufacturer's authorization.

How to protect and increase life expectancy for the lifter? The following will be the best ways that you need:

## INSPECTIONS

Check the Handy Vacuum Lifter carefully and regularly to avoid the following faults:

- Contamination or debris on vacuum pads and load surfaces.
- Visual damages of the lifter's structure and vacuum system.
- Listen for unusual vibration or noise while operating the lifter.
- Cracks, cuts, corrosion or any deficiency affected entire lifter.
- Missing parts.
- Damaged edges of the device while sealing.
- Repair all faults before using the lifter.

## MAINTENANCE

A good maintenance planning will bring benefits for your lifter. It not only increases safety and using values, but also reduces maintenance cost:

- Perform maintenance periodically.
- Perform simple maintenance tasks for the lifter such as repairing, replacing grease so that the lifter runs smoothly.
- Check the rubber pads to ensure that they are free from dirt and damages.
- You must clean the air filter to eliminate dust or contamination.
- Release the water in the vacuum tank is located on the bottom by screwing the air outlet valve.
- If the lifter is used for less than one day in a two-week period, you should perform an inspection and maintenance to ensure that the lifter is safe and does not have any faults.
- The lifter may experience normal wear and tear and ageing. You should replace any reduced quality parts with new original parts.
- The lifter and hoisting accessories must be stored in a place where they are protected against weather conditions and aggressive substances.



After receiving the product, the buyer should check, based on the spare parts list and spare drawings attached to the product, that the spare parts have not been damaged or lost during shipment. Any damages or losses must be officially reported to The Aardwolf Industries LLC within eight days from the date of purchase.

This lifter is granted a 12-month warranty based on The Aardwolf Industries LLC's warranty policy from the date of purchase.

The warranty coverage is not applicable when:

- The lifter is handled incorrectly during manoeuvring.
- The operator fails to comply with the instructions in this manual.
- The lifter's maximum permissible capacity is exceeded.
- The specifications for stone slab thickness are not followed.
- Damages are due to inadequate maintenance and inspections.
- Damage is due to improper storage.
- Repairs were performed by the user without our permission.
- Unofficial spare parts were used.

### DISCLAIMER:

The Aardwolf Industries LLC's warranty does not cover the incorrect assembly and misuse of the lifter, the lack of maintenance and repair of the lifter as scheduled by the manufacturer, the operation carried out by non-competent or non-authorised operators or unofficial spare parts being used or installed.

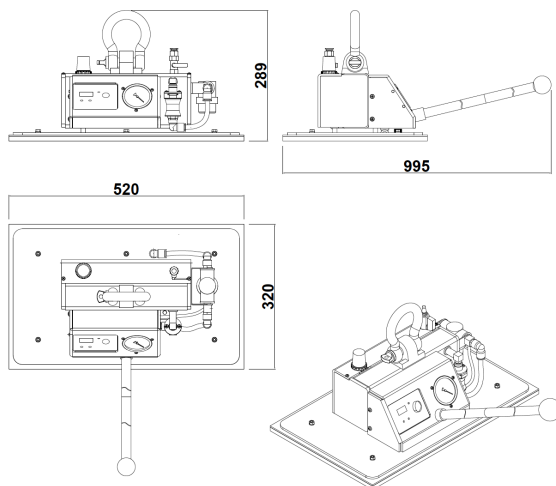



## VIETNAM

### AARDWOLF VIETNAM

- 📍 1B, An Phu, Thuan An, Binh Duong, Vietnam.
- ☎ +84 274 371 2827438/39
- ✉ sales@aardwolf.com.vn
- 🌐 www.aardwolf.com.vn

## AUSTRALIA

### AARDWOLF AUSTRALIA

- 📍 Unit 1, 5 Stanton Road, Seven Hills NSW 2147 Australia.
- ☎ +0422 916 907
- ✉ enquiries@aardwolfaustralia.com
- 🌐 www.aardwolfaustralia.com

## GERMANY

### STONE GLASS EQUIPMENT UG

- 📍 Am Gutsteich 11, 08451 Crimmitschau/ Blankenhain, Germany.
- ☎ +49 366 0821 9236
- ✉ sales@aardwolf.com.de
- 🌐 www.aardwolf.com.de

## INDIA

### AARDWOLF KISHANGARH

- 📍 Harmara Road, Industrial Area, Madanganj, Kishangarh, Rajasthan India / Pin no. 305801
- ☎ Tel: +91 93584 48474
- ✉ sales@aardwolf.co.in
- 🌐 Web: www.aardwolf.co.in

### AARDWOLF BENGALURU

- 📍 No: 6, Sharma Complex, 3rd Cross, Ganesha Block, Dinnur Main Road, R. T. Nagar P.O Bengaluru-560032
- ☎ +91 98451 62959/ 91 99017 24600
- ✉ bengaluru@aardwolf.co.in
- 🌐 www.aardwolf.co.in

### AARDWOLF MUMBAI

- ☎ +91 97659 06007
- ✉ mumbai@aardwolf.co.in
- 🌐 www.aardwolf.co.in

