



# HORIZONTAL STONE LIFTING CLAMP

## OWNER'S MANUAL

**PRODUCT CODE: AHLC-2010**



**SPECIFICATIONS & FEATURES** ▶ **SAFETY INSTRUCTIONS** ▶ **PART DRAWING & PART LIST**  
**INSTRUCTIONS FOR USE** ▶ **INSPECTIONS, MAINTENANCE & REPAIR** ▶ **WARRANTY**

The Horizontal Stone Lifting Clamp 2010 is a hoisting accessory for lifting and moving large dimension stone, concrete slabs, and blocks. This clamp incorporates a latch that automatically releases the lifter from the load once the load has been fully lowered to the ground.

The purpose of this manual is to assist you in the correct use of Horizontal Stone Lifting Clamp, and to provide information on its safe use. It must be used only for this using purpose.



# 1. SPECIFICATIONS & FEATURES

## 1.1 Specifications:

	<b>Metric</b> (mm-kg)	<b>Imperial</b> (inch-lb)
Grip range	280 - 2010	11" – 79"
Working load limit	1500	3307
Net weight	137	302
Gross weight	155	342
Packaging dimensions	2450 x 530 x 360	96.5" x 20.9" x 14.2"

## 1.2 Features:

- Adjustable jaw opening width.
- A large gripping range, making it suitable for a wide range of applications.
- Long-lasting, high friction replaceable Polyurethane gripping pads.
- Lifting eye for attaching to a crane hook.
- Auto locks and unlocks the load.

# 2. SAFETY INSTRUCTIONS

To ensure safety during operation, you must carefully read these instructions to avoid injury, death or damage while using the AHLC-2010:

- Determine whether the capacity of a crane hook or forklift boom is suitable for use with the lifter.
- Determine the capacity of the crane hook or forklift boom (when applicable) that is suitable for the maximum load weight plus clamp weight.
- Perform a load test for the lifter before handling the load.
- Carefully read the device manual before operating.
- Only competent and authorized personnel should operate the device.
- Follow the safety regulations stipulated by local authorities.
- Ensure that the manual is available during operation.
- Always wear appropriate protective equipment like helmet, gloves, safety boots.
- Always check clamp. If clamp is worn or damaged, do not use it.



## 2. SAFETY INSTRUCTIONS

- Make sure that the surface of the clamping jaws is clean.
- Perform the load test to ensure that the lifter is safe before using it.  
The load must not exceed the maximum allowable weight specified show on lifter.
- The load must be a single slab with a smooth or rough and non-porous surface.
- Size of the load must be a within gripping range specified from the manufacturer.
- The grip depends on friction so that do not lift the wet block and lifting wet-block may cause the rubber pads to lose their grip. It must be checked that the rubber pads are free from dirt, grease.
- Do a risk assessment of the material that is being lifted. The load must be free of fractures and other defects that may cause the slabs to fall apart while being lifted.
- Connections or individual parts of hoisting accessories should never be able to loosen by themselves.
- Defect hoisting accessories are no longer to be used.
- To avoid injury, no one is allowed to stand under the load.
- Do not carry out any lifting operations if any issues are found.
- Never operate a lifter that is damaged, malfunctioning or missing parts.
- Never operate a lifter if the tables for load capacity or any other warnings are missing, obscure or unclear.
- All inspections and tests must be carried out before lifting.
- Make sure that there are no obstructions during the working process.

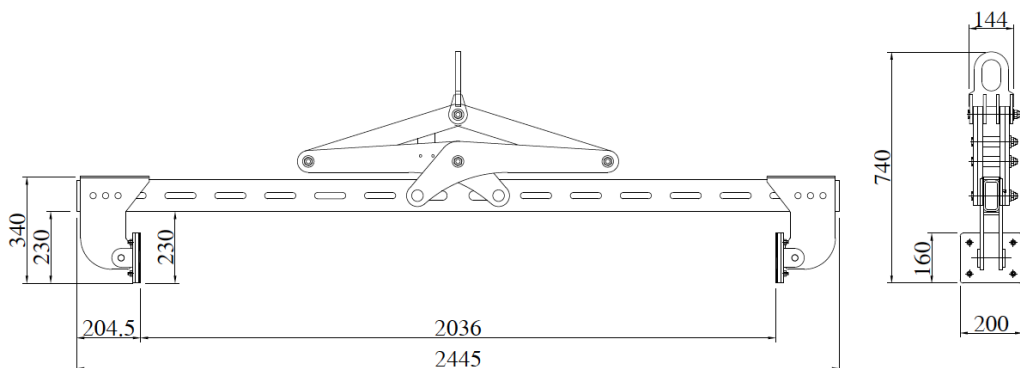

### 3. PART DRAWING & PART LIST

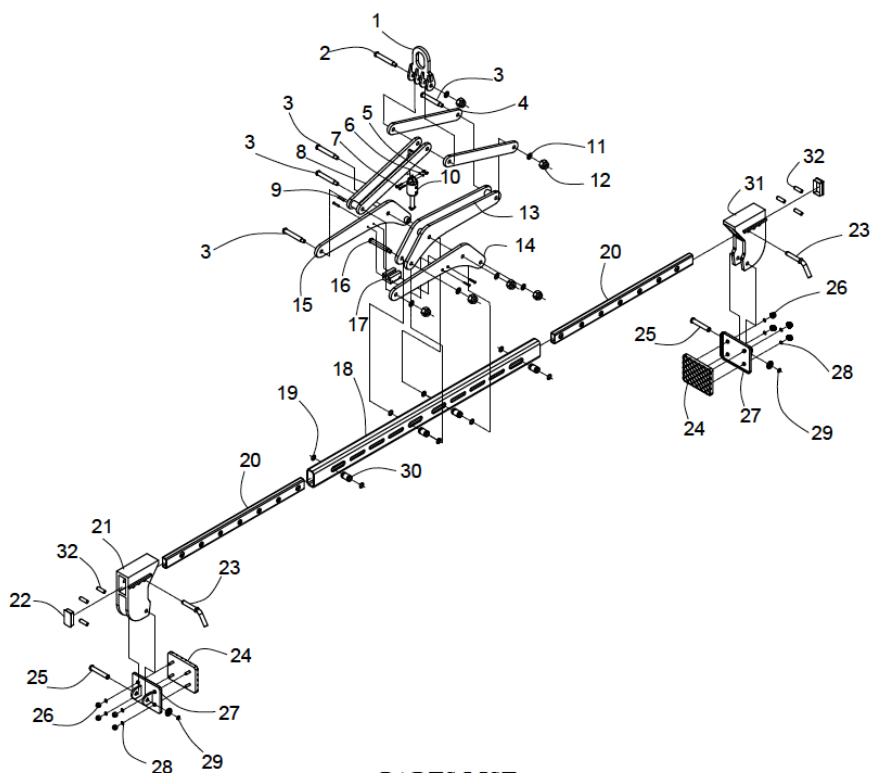

#### PARTS LIST

CODE	POS.	DESCRIPTION	QTY
AHLC2010 - 001	1	Hook	01
AHLC2010 - 002	2	Pin 1	01
AHLC2010 - 003	3	Pin 2	04
AHLC2010 - 004	4	Right Upper Arm	02
AHLC2010 - 005	5	Hexagon Nylon Nut M8	02
AHLC2010 - 006	6	Washer Ø8	02
AHLC2010 - 007	7	Socket Head Cap Screw M8x40	02
AHLC2010 - 008	8	Left Upper Arm	01
AHLC2010 - 009	9	Countersunk Screw M8x30	04
AHLC2010 - 010	10	Locking Body	01
AHLC2010 - 011	11	Washer Ø20	16
AHLC2010 - 012	12	Hexagon Nylon Nut M20	06
AHLC2010 - 013	13	Right Lower Arm	01
AHLC2010 - 014	14	Left Lower Arm 1	01
AHLC2010 - 015	15	Left Lower Arm 2	01
AHLC2010 - 016	16	Pin 3	01

CODE	POS.	DESCRIPTION	QTY
AHLC2010 - 017	17	Locking Base	01
AHLC2010 - 018	18	Cross Bar	01
AHLC2010 - 019	19	Circlips Ø30	08
AHLC2010 - 020	20	Slide Bar	02
AHLC2010 - 021	21	Left Arm	01
AHLC2010 - 022	22	Plastic Cap 100x50x6	02
AHLC2010 - 023	23	Pin 4	02
AHLC2010 - 024	24	Rubber Pad	02
AHLC2010 - 025	25	Pin 5	02
AHLC2010 - 026	26	Nylon Nut M10	08
AHLC2010 - 027	27	Jaw	02
AHLC2010 - 028	28	Washer Ø10	08
AHLC2010 - 029	29	Circlips Ø20	02
AHLC2010 - 030	30	Bush	04
AHLC2010 - 031	31	Right Arm	01
AHLC2010 - 032	32	Steel Ball	06

When ordering, please give number of spare - part (code number) plus type of Horizontal Stone Lifting Clamp - 2010.

For example: Horizontal Stone Lifting Clamp AHLC2010 - 001 , QTY 10

Horizontal Stone Lifting Clamp AHLC2010 - 004 , QTY 02

Updated date: June 22<sup>th</sup>, 2020



The Horizontal Stone Lifting Clamp works perfectly and effectively for lifting and transporting a large stone slab. Before use and during the working process, you must adhere to the instructions below:

**Step 1:** Connect the Horizontal Stone Lifting Clamp 2010 to a crane hook or forklift boom to start.



**Step 2:** Move the device to the material being lifted.

**Step 3:** Adjust the gripping range of the lifter so that it is suitable for size of block to pick up.



**Step 4:** Position of the clamp is square with the block to be lifted and the load is balanced.



**Step 5:** Lower the lifter onto the load and make sure that the block is inserted to full depth into the clamping jaws of the clamp.



**Step 6:** Raise the hoist to allow clamping jaws to close onto the load. Then lift and move the block slowly so that the load is balanced to desired location.

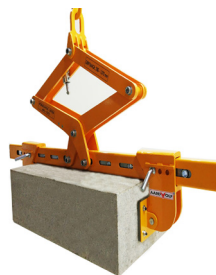

**Step 7:** Place it down and the latch on the left upper arm will automatically lock the lifter. You raise the hoist to remove the lifter out of the material.



**CAUTION:** You are only allowed to lift a load at one time.

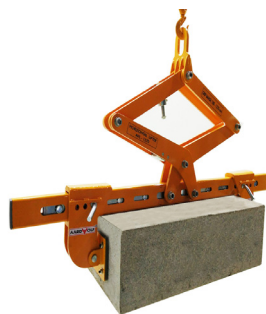

**CE – Declaration of conformity:** we declare that the lifter is in conformity with the following standard: The Machinery Directive 2006/42/EC.

**NOTE:** It is the responsibility of the user to adapt to state or local laws. The end user is responsible for using the equipment safely in the manner that it is designed for and within the rated capacity of the unit.

## 5. INSPECTIONS, MAINTENANCE & REPAIR

How to protect and increase life expectancy for the clamp? Below guidelines will be the best ways that you need to follow:

### INSPECTIONS:

Check the AHL-2010 regularly to make sure it does not exhibit the following faults:

- Check the lifter's structure for visual damage.
- Check the rubber pads to ensure they are clean.
- Check for unusual vibrations or noise while operating the lifter.
- Check the entire lifter for cracks, cuts, corrosion or any deficiency.
- Check that the lifter has no missing parts.
- Check that the edges of the lifter are not cut or damaged while sealing.
- Repair all faults before using the clamp.

### MAINTENANCE:

A good maintenance planning will bring benefits for your clamp. It does not only increase safety and using values, but also reduce maintenance cost. So what should you do?

- Perform maintenance periodically.
- Perform simple maintenance tasks for the lifter such as repairing, replacing



grease so that the lifter runs smoothly.

- Check the rubber pads to ensure that they are free from dirt and that the edges of the rubber pads are not cut or damaged.
- If the lifter is used for less than one day in a two weeks, you should perform an inspection and maintenance to ensure that the lifter is safe and does not have any faults.
- The lifter may experience normal wear and tear and aging. You should replace any reduced quality parts with new original parts.
- The lifter and hoisting accessories must be stored in a place where they are protected against weather conditions and aggressive substances.

## 6. WARRANTY

After receiving the product, the buyer should check, based on the spare parts list and spare drawings attached to the product, that the spare parts have not been damaged or lost during shipment. Any damages or losses must be officially reported to The Aardwolf Industries LLC within eight days from the date of purchase.

This lifter is granted a 12-month warranty based on The Aardwolf Industries LLC's warranty policy from the date of purchase.

2. The warranty coverage is not applicable:

- The lifter is handled incorrectly during maneuvering.
- The user fails to comply with the instructions in this booklet.
- The lifter's maximum permissible capacity is exceeded.
- The specifications for stone thickness are not followed.
- Damages are due to inadequate maintenance and inspections.
- Damage is due to improper storage.
- Repairs were performed by the user without our permission.
- Unofficial spare parts were used.

### **DISCLAIMER:**

The Aardwolf Industries LLC's warranty does not cover the incorrect assembly and misuse of the lifter, the lack of maintenance and repair of the lifter as scheduled by the manufacturer, the operation carried out by non-competent or non-authorized operators or unofficial spare parts being used or installed.



## VIETNAM

### AARDWOLF VIETNAM

- 📍 1B, An Phu, Thuan An, Binh Duong, Vietnam.
- ☎ +84 274 371 2827438/39
- ✉ sales@aardwolf.com.vn
- 🌐 www.aardwolf.com.vn

## AUSTRALIA

### AARDWOLF AUSTRALIA

- 📍 Unit 1, 5 Stanton Road, Seven Hills NSW 2147 Australia.
- ☎ +0422 916 907
- ✉ enquiries@aardwolfaustralia.com
- 🌐 www.aardwolfaustralia.com

## GERMANY

### STONE GLASS EQUIPMENT UG

- 📍 Am Gutsteich 11, 08451 Crimmitschau/ Blankenhain, Germany.
- ☎ +49 366 0821 9236
- ✉ sales@aardwolf.com.de
- 🌐 www.aardwolf.com.de

## INDIA

### AARDWOLF KISHANGARH

- 📍 Harmara Road, Industrial Area, Madanganj, Kishangarh, Rajasthan India / Pin no. 305801
- ☎ Tel: +91 93584 48474
- ✉ sales@aardwolf.co.in
- 🌐 Web: www.aardwolf.co.in

### AARDWOLF BENGALURU

- 📍 No: 6, Sharma Complex, 3rd Cross, Ganesha Block, Dinnur Main Road, R. T. Nagar P.O Bengaluru-560032
- ☎ +91 98451 62959/ 91 99017 24600
- ✉ bengaluru@aardwolf.co.in
- 🌐 www.aardwolf.co.in

### AARDWOLF MUMBAI

- ☎ +91 97659 06007
- ✉ mumbai@aardwolf.co.in
- 🌐 www.aardwolf.co.in

