



# AARDWOLF FOLDING A-FRAME

**OWNER'S MANUAL**

**PRODUCT CODE: FAF-1600**



## CONTENTS

- GENERAL ▶ FEATURES ▶ TECHNICAL SPECIFICATIONS ▶ SAFETY INSTRUCTIONS
- PART DRAWING & PART LIST ▶ INSTRUCTIONS FOR USE ▶ INSPECTIONS, MAINTENANCE & REPAIR
- ▶ WARRANTY ▶



## 1. GENERAL

Hauling granite and marble isn't easy, and it certainly is not safe if you don't have the right equipment. A well-made transporting frame is necessary for both the safety of the driver and other workers, as well as for the protection of the granite and marble.

The sturdy Aardwolf Folding A-Frame, with its unique integrated vertical locking bars and ratchet locking straps, is designed to hold all material safely and securely, which eliminates risks to the operator and prevents damage to materials. The load is secured independently on each side by two vertical locking bars, which are inserted into brackets at the base of the frame and held by ratchet locking straps at the top.

The unloaded frame can be folded up by the simple withdrawing of two spring-loaded pins from the cross braces and the lowering of the three wheels at one end by means of a cam lever. The lowered wheels also allow the frame to be positioned on the tray of a truck or manually moved around the factory.

## 2. FEATURES

- Bolt holes in the base of the frame for optionally securing the Folding A-Frame to the vehicle.
- Granite is secured by rubber pads mounted on cleats, which are in turn adjustable in height along the vertical locking bars.
- Large hand-tightened wing nuts are used to tighten the cleats to the vertical locking bars.
- Pockets on the base at the corners to receive the safety post.
- Powder-coated finish.



3. TECHNICAL SPECIFICATIONS

	Metric (mm-kg)	Imperial (inch-lb)
Width of slab storage base area on each side	386	15.2"
Working load limit	6000	13228
Net weight	171	377
Gross weight	172	379
Packaging dimensions	1650 x 420 x 1740	65" x 16.5" x 68.5"

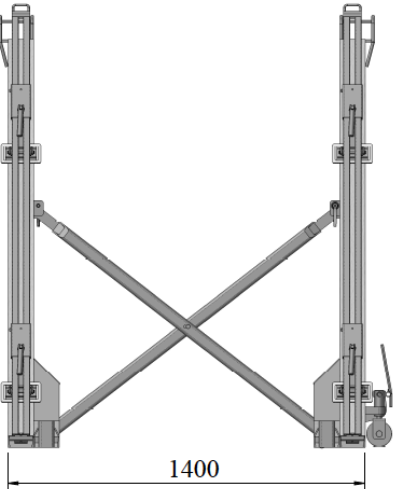
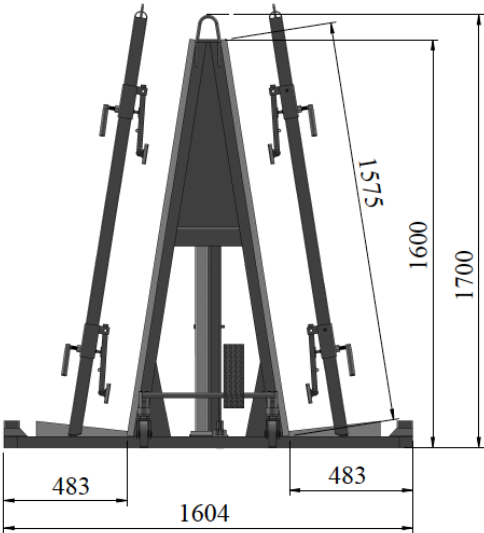

- Make sure that this manual is always available to workers and operators involved in loading and unloading the Folding 'A'-Frame.
- Read the operating manual carefully before you use Folding A-Frame.
- Carefully consider all safety regulations and existing standards and codes in your country for transporting granite and marble slabs on the back of trucks.
- Implement correct loading procedures and follow all the safety related work-practices.
- Permission to use and work with the Folding A-Frame should only be given to persons who are suitably trained, competent and acquainted with this operating manual and safety regulations.
- Wear safety equipment, like helmet, gloves and safety boots.
- Operating personnel must stand so that they always have a full view of raising/lowering movements of slabs being loaded or unloaded from the Folding 'A' Frame.
- Visitors and customers must be kept away from the area while slabs are being loaded or unloaded from the frame.
- Never leave slabs unsecured.
- While transporting loaded frame avoid turns at high speed. Sudden stops and starts should also be avoided.
- Restraining devices and tie-downs should be properly applied and removed. The restraining devices and tie downs should be inspected before being applied and prior to being removed. Restraining devices and tie-downs that do not pass inspection should be removed.
- Truck drivers should visually check the frame and load for any damage during transit.

Connections or individual parts of Folding A-Frame should never be able to loosen by them selves.
- Folding A-Frame must be stored in a place where they are protected against weather conditions and aggressive substances
- Defect or damaged Folding A-Frame are no longer to be used.
- Repairs and checks are to be made only by qualified persons.





## 5. PART DRAWING & PART LIST

### ASSEMBLY DIAGRAM & PART LIST FAF-1600

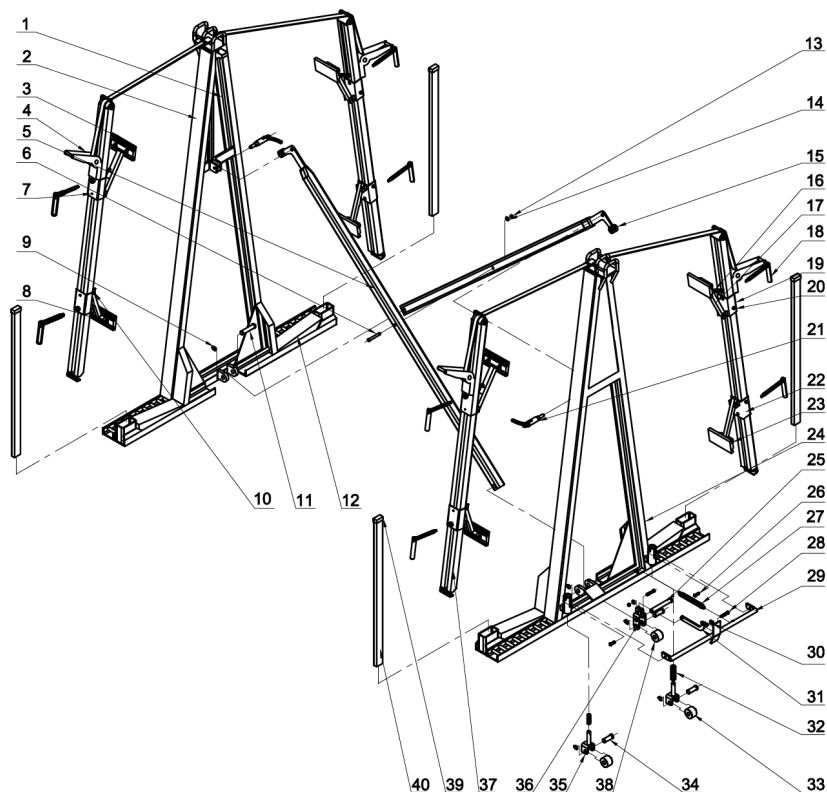

CODE	POSITION	DESCRIPTION	QTY
FAF1600 - 001	1	Left Body	01
FAF1600 - 002	2	Woods	04
FAF1600 - 003	3	Jaw + Rubber	08
FAF1600 - 004	4	Stap Ratchet	04
FAF1600 - 005	5	Cross Bar	02
FAF1600 - 006	6	Pin Ø12	01
FAF1600 - 007	7	Hexagon Bolt M6x20	08
FAF1600 - 008	8	Pin Ø12	08
FAF1600 - 009	9	Circlip Ø20	05
FAF1600 - 010	10	Hexagon Bolt + Nut M10x40	08
FAF1600 - 011	11	Pin Ø20	01
FAF1600 - 012	12	Wooden Gluts	04
FAF1600 - 013	13	Hexagon Nut M12	01
FAF1600 - 014	14	Washer Ø12	17
FAF1600 - 015	15	Slide Bearing	04
FAF1600 - 016	16	Springs	04
FAF1600 - 017	17	Arm	08
FAF1600 - 018	18	Locking Handle	08
FAF1600 - 019	19	Upper Slide	04
FAF1600 - 020	20	Wing Bolt M8x30	08

CODE	POSITION	DESCRIPTION	QTY
FAF1600 - 021	21	Load Locking Pin	02
FAF1600 - 022	22	Lower Slide	04
FAF1600 - 023	23	Circlips Ø12	16
FAF1600 - 024	24	Right Body	01
FAF1600 - 025	25	Pin Ø20	01
FAF1600 - 026	26	Countersink Screw M10	02
FAF1600 - 027	27	Extension Spring	01
FAF1600 - 028	28	Hexagon Bolt + Nut M10	02
FAF1600 - 029	29	Cam Lever	01
FAF1600 - 030	30	Washer Ø10	02
FAF1600 - 031	31	Push Lever	01
FAF1600 - 032	32	Compression Spring	02
FAF1600 - 033	33	Pressure Wheel	02
FAF1600 - 034	34	Pin	03
FAF1600 - 035	35	Base Wheel	01
FAF1600 - 036	36	Inner Base Wheel	01
FAF1600 - 037	37	Securing Bar	04
FAF1600 - 038	38	Pressure Wheel	01
FAF1600 - 039	39	Plastic Cap 100x50	04
FAF1600 - 040	40	Safety Post 100x50x5 - 1400	04

When ordering, please give number of spare - part (code number) plus type of Folding A Frame. For example: FAF1600-008, QTY 10

FAF1600-018, QTY 02

Updated date: Jun 03<sup>th</sup>, 2020



General safety instructions for loading, transporting and unloading folding A' frame.

Important! In order to protect people from getting injured it is important to follow some general safety directions while loading and unloading Folding 'A' Frames.

1. Park truck on level even ground.
2. Inspect frame before use. If the frame is damaged, do not use.
3. Effectively secure the Folding A-Frame to the truck.
4. Determine the weight of the slabs to be transported. Do not exceed working load limit shown on frame.
5. Do a risk assessment of the material that is being transported. The slab must be free of fractures and other defects that may cause the slab to fall apart while being transported.
6. If loading slabs of different size, load larger slab first.
7. Secure load by placing securing bars in appropriate cleats at base of frame and attach top of bar to frame with ratchet load straps. Adjust locking pads on securing bar to suit slab size. Tighten pads against load.
8. Fully secure load on one side with securing bars before loading second side.
9. Ensure that load is approximately balanced in weight on both sides of the frame.
10. Fasten frame and load securely in place on truck by passing tie down straps or chain through the guide brackets at the top of each 'A' frame.
11. When unloading slabs: Before removing securing bars from the frame put safety posts in place.

**Warning!** The slabs can shift or fall if the restraining devices have been improperly placed.

**Important:** When unloading slabs: Before removing securing bars from the frame put safety posts in place.



It is important to establish a regular procedure for Folding A-Frame inspection. Frequency of inspection will depend upon the amount of use the Folding A-Frame receives. You may wish to maintain a written record, indicating inspection dates, condition of the Folding A-Frame on each of those dates, and any repairs made. Inspection records should be reviewed periodically. Always use qualified maintenance persons when carrying out repairs or maintenance.

### CE - DECLARATION OF CONFORMITY

We declare that the product is in conformity with the following standard. The Machinery Directive 98/37 /EC

**Note:** It is the responsibility of the user to adapt to country or local laws.

## 8. WARRANTY

At the time of delivery it is necessary to check that the Folding A-Frame has not been damaged during shipment. Any claims must be presented within 8 days of the date of delivery of the product. This product is warranted for one year from date of purchase to be free of manufacturing defects in material and workmanship.

The warranty coverage is not applicable:

- The Folding A-Frame is handled incorrectly during maneuvering.
- The operator fails to comply with the instructions in this booklet.
- The Folding A-Frame maximum permissible capacity is exceeded.
- Damages are due to inadequate maintenance and inspections.
- Damage is due to improper storage.



## VIETNAM

### AARDWOLF VIETNAM

- 📍 1B, An Phu, Thuan An, Binh Duong, Vietnam.
- ☎ +84 274 371 2827438/39
- ✉ sales@aardwolf.com.vn
- 🌐 www.aardwolf.com.vn

## AUSTRALIA

### AARDWOLF AUSTRALIA

- 📍 Unit 1, 5 Stanton Road, Seven Hills NSW 2147 Australia.
- ☎ +0422 916 907
- ✉ enquiries@aardwolfaustralia.com
- 🌐 www.aardwolfaustralia.com

## GERMANY

### STONE GLASS EQUIPMENT UG

- 📍 Am Gutsteich 11, 08451 Crimmitschau/ Blankenhain, Germany.
- ☎ +49 366 0821 9236
- ✉ sales@aardwolf.com.de
- 🌐 www.aardwolf.com.de

## INDIA

### AARDWOLF KISHANGARH

- 📍 Harmara Road, Industrial Area, Madanganj, Kishangarh, Rajasthan India / Pin no. 305801
- ☎ Tel: +91 93584 48474
- ✉ sales@aardwolf.co.in
- 🌐 Web: www.aardwolf.co.in

### AARDWOLF BENGALURU

- 📍 No: 6, Sharma Complex, 3rd Cross, Ganesha Block, Dinnur Main Road, R. T. Nagar P.O Bengaluru-560032
- ☎ +91 98451 62959/ 91 99017 24600
- ✉ bengaluru@aardwolf.co.in
- 🌐 www.aardwolf.co.in

### AARDWOLF MUMBAI

- ☎ +91 97659 06007
- ✉ mumbai@aardwolf.co.in
- 🌐 www.aardwolf.co.in

