

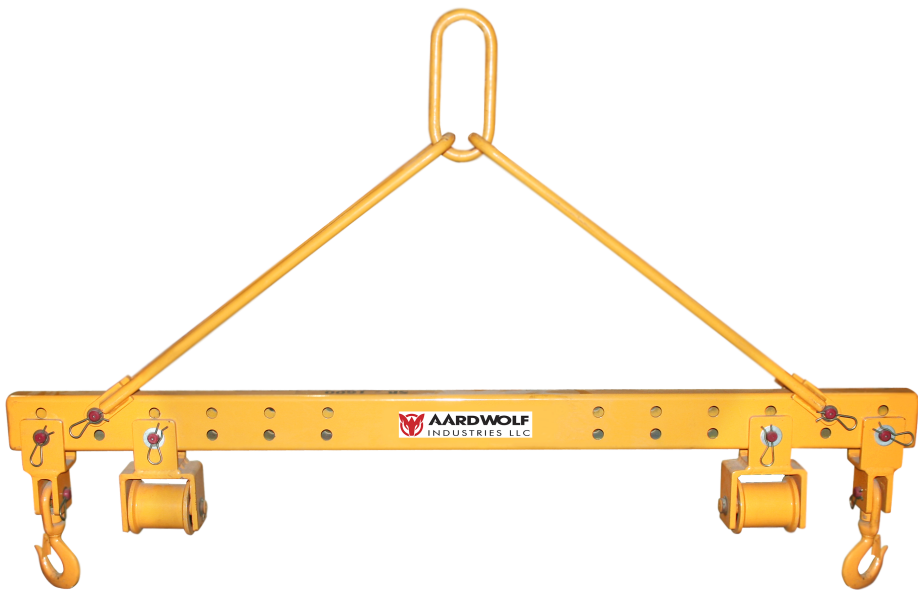

# SPREADER BEAM 3.5 TONS

**OWNER'S MANUAL****PRODUCT CODE: ASB-3.5T****CONTENTS**

**SPECIFICATIONS & FEATURES** ▶ **SAFETY INSTRUCTIONS** ▶ **PART DRAWING & PART LIST**  
**INSTRUCTIONS FOR USE** ▶ **INSPECTIONS, MAINTENANCE & REPAIR** ▶ **WARRANTY**

Specifically designed for the stone industry. The Spreader Beam, in combination with endless slings, is an invaluable piece of equipment where stone is required to be rolled over. The slings are suspended on crowned aluminium rollers. This makes turning the load in the sling easier. The rollers will handle up to 90mm wide slings. The swivel hooks can be used in place of rollers. The overall width is 2000mm.



# 1. SPECIFICATIONS & FEATURES

## 1.1 Specifications:

	<b>Metric</b> (mm-kg)	<b>Imperial</b> (inch-lb)
Working load limit	3500	7716
Net weight	73	161
Gross weight	74	163
Packaging dimensions	2020 x 150 x 280	79.5" x 5.9" x 11"

## 1.2 Features:

- Adjustable lifting points.
- Handle both wide and unbalanced loads.
- Optional: Swivel hooks.

# 2. SAFETY INSTRUCTIONS

To ensure safety during operation, the operator must carefully read these instructions to avoid injury, death or damage while using the Spreader Beam: Must be operated only by personnel who are well trained with this operating manual and safety regulations.

- Always inspect the Spreader Beam and if any parts are worn or damaged, do not use.
- Determine the suitable capacity of a crane or forklift boom when they are used with the Spreader Beam.
- The load must not exceed the maximum allowed weight specified.
- Perform a load test to ensure the Spreader Beam is safe before using.
- Read the manual carefully and ensure that it is always available during operation.
- The Spreader Beam should be slowly lifted to secure balance.
- Wear proper safety clothing and gear.
- Never leave suspended loads unattended.

- To avoid injury, never allow anyone to work under a suspended load.
- Never operate the Spreader Beam if the tables for the load capacity are missing or unclear.
- Never make alterations or modifications to a Spreader Beam.
- Ensure that there are no obstructions during the lifting operation.
- Attach the Spreader Beam to a crane or forklift boom and ensure that the capacity of the crane or forklift boom is suitable for the Spreader Beam.
- In the event that slings are used to lift or roll stones, the total capacity of both slings must be equal to or greater than the Spreader Beam.
- Ensure that the slings or shackles are not twisted and are equal in length and spacing on the Spreader Beam.

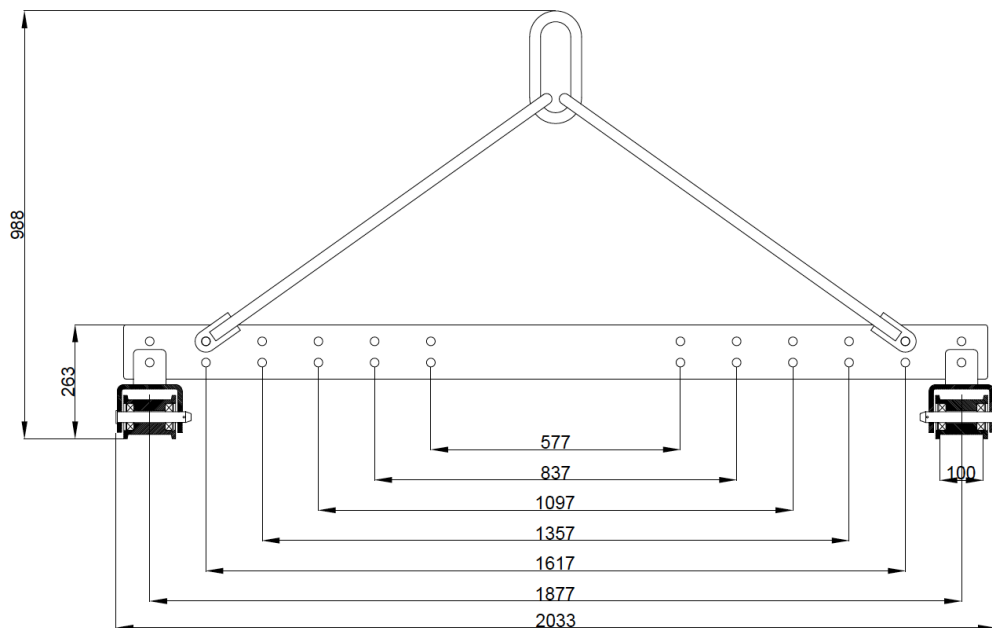

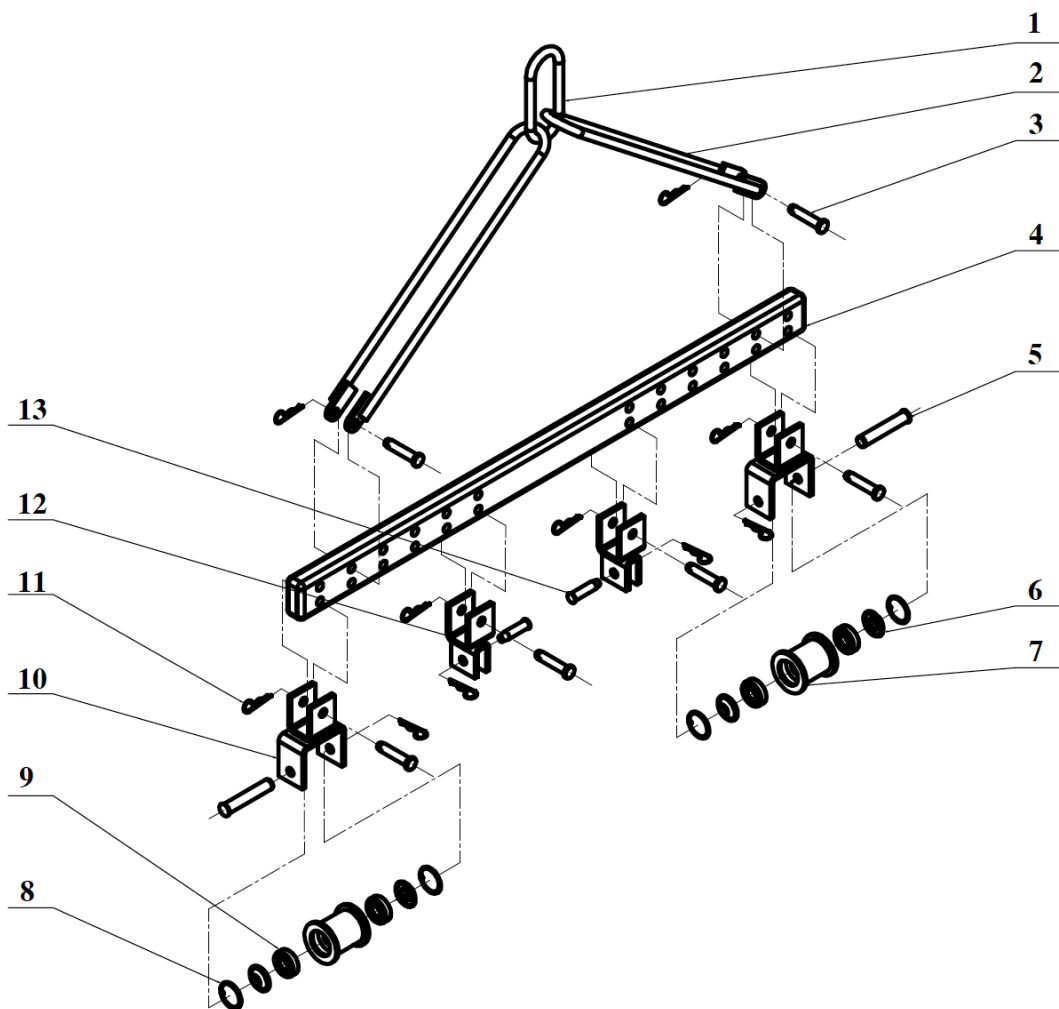



CODE	POSITION	DESCRIPTION	QTY
ASB35T - 001	1	LIFTING MASTER RING	01
ASB35T - 002	2	LIFTING HANDLE	02
ASB35T - 003	3	PIN 1	06
ASB35T - 004	4	CROSS BAR	01
ASB35T - 005	5	PIN 2	02
ASB35T - 006	6	COLLAR	04
ASB35T - 007	7	WHEEL	02
ASB35T - 008	8	CIRCLIP Ø62	04
ASB35T - 009	9	BEARING	04
ASB35T - 010	10	HOLDER	02
ASB35T - 011	11	SPLIT PIN	10
ASB35T - 012	12	SUSPENSION HOOK	02
ASB35T - 013	13	PIN 3	02

**When ordering, please give number of spare - part (code number) plus type of Spreader Bar - 3.5Tons.**  
**Example: ASB35T - 006 , QTY 02**  
**ASB35T - 010 , QTY 01**

- Adjust the lifting handle position, holders and rollers so that they are suitable for the size of the stone slabs on the Spreader Beam:
  - The cross bar includes two lines of positions: the upper is to adjust the length of two lifting handles and the lower is to adjust the length of two rollers or swivel hooks.
  - Adjust the bar to the desired length by using the pins and cotter pins to securely attach the roller or swivel hooks to the cross bar.
  - The distance between the suspension hooks are 130 mm.
- Unlock the pin and cotter pin to insert the slings into the wheel, or shackles into the swivel hook, to roll the stone. After that, the operator must symmetrically place the stone inside two slings or two shackles to ensure safety during the moving process.
- The operator can adjust the stone to move in a vertical or horizontal direction.
- Now, the equipment is able to move the stone to the desired location by crane or forklift boom.
- Slowly lower the stone.
- Keep the slings or shackles in storage when not in use.

### **CE - Declaration of conformity:**

We declare that the product is in conformity with the following standard: the machinery Directive 2006/42/EC.

**Note:** It is the responsibility of the user to adapt to state or local laws. The end user is responsible for using the equipment safely in the manner that it is designed for and within the rated capacity of the unit.



### 5.1 Inspections:

Check the entire equipment for cracks, cuts, corrosion or any deficiency:

- The equipment has no missing parts.
- The welds to ensure that they are safe before using.
- The pins and cotter pins are not falling out.
- The slings or shackles are not damaged.
- Repair all faults before using the equipment.

### 5.2 Maintenance:

The maintenance procedures should be established as mandatory regulations and policies. They vary depending on the amount and purpose of use, and the buyer's own policy. As normal, it should include the frequency of inspection, the policy for defects found and repaired and the policy for record filing.

## 6. WARRANTY

This Lifter is granted a 12-month warranty based on Aardwolf Industries LLC's warranty policy from the date of purchase:

1. To obtain repair or warranty service: After receiving the goods, the buyer is strongly advised to check, based on the spare parts list and spare drawing attached with the goods, that the spare parts have not been damaged or lost during shipment. Any damages or losses must be officially reported to Aardwolf Industries LLC's within eight days of the date of receipt.
2. The warranty coverage is not applicable:
  - The Spreader Beam is handled incorrectly during manoeuvring.
  - The operator fails to comply with the inspections in the booklet.
  - The maximum permissible capacity of the Spreader Beam is exceeded.
  - The specifications are not allowed.
  - Damages are due to inadequate maintenance and inspections.
  - Repairs were performed by the user without our permission.
  - Unofficial spare parts were used.
3. Disclaimer: The Aardwolf Industries LLC's warranty does not cover the incorrect assembly and misuse by the handler, the lack of maintenance and repair of the Spreader Beam, the operation by non-competent or non-authorised users or unofficial spare parts being used or installed.



## VIETNAM

### AARDWOLF VIETNAM

- 1B, An Phu, Thuan An, Binh Duong, Vietnam.
- +84 274 371 2827438/39
- sales@aardwolf.com.vn
- www.aardwolf.com.vn

## AUSTRALIA

### AARDWOLF AUSTRALIA

- Unit 1, 5 Stanton Road, Seven Hills NSW 2147 Australia.
- +0422 916 907
- enquiries@aardwolfaustralia.com
- www.aardwolfaustralia.com

## GERMANY

### STONE GLASS EQUIPMENT UG

- Am Gutsteich 11, 08451 Crimmitschau/ Blankenhain, Germany.
- +49 366 0821 9236
- sales@aardwolf.com.de
- www.aardwolf.com.de

## INDIA

### AARDWOLF KISHANGARH

- Harmara Road, Industrial Area, Madanganj, Kishangarh, Rajasthan India / Pin no. 305801
- Tel: +91 93584 48474
- sales@aardwolf.co.in
- Web: www.aardwolf.co.in

### AARDWOLF BENGALURU

- No: 6, Sharma Complex, 3rd Cross, Ganesha Block, Dinnur Main Road, R. T. Nagar P.O Bengaluru-560032
- +91 98451 62959/ 91 99017 24600
- bengaluru@aardwolf.co.in
- www.aardwolf.co.in

### AARDWOLF MUMBAI

- +91 97659 06007
- mumbai@aardwolf.co.in
- www.aardwolf.co.in

