



OWNER'S MANUAL

AARDWOLF

GLASS LIFTER

AGL32

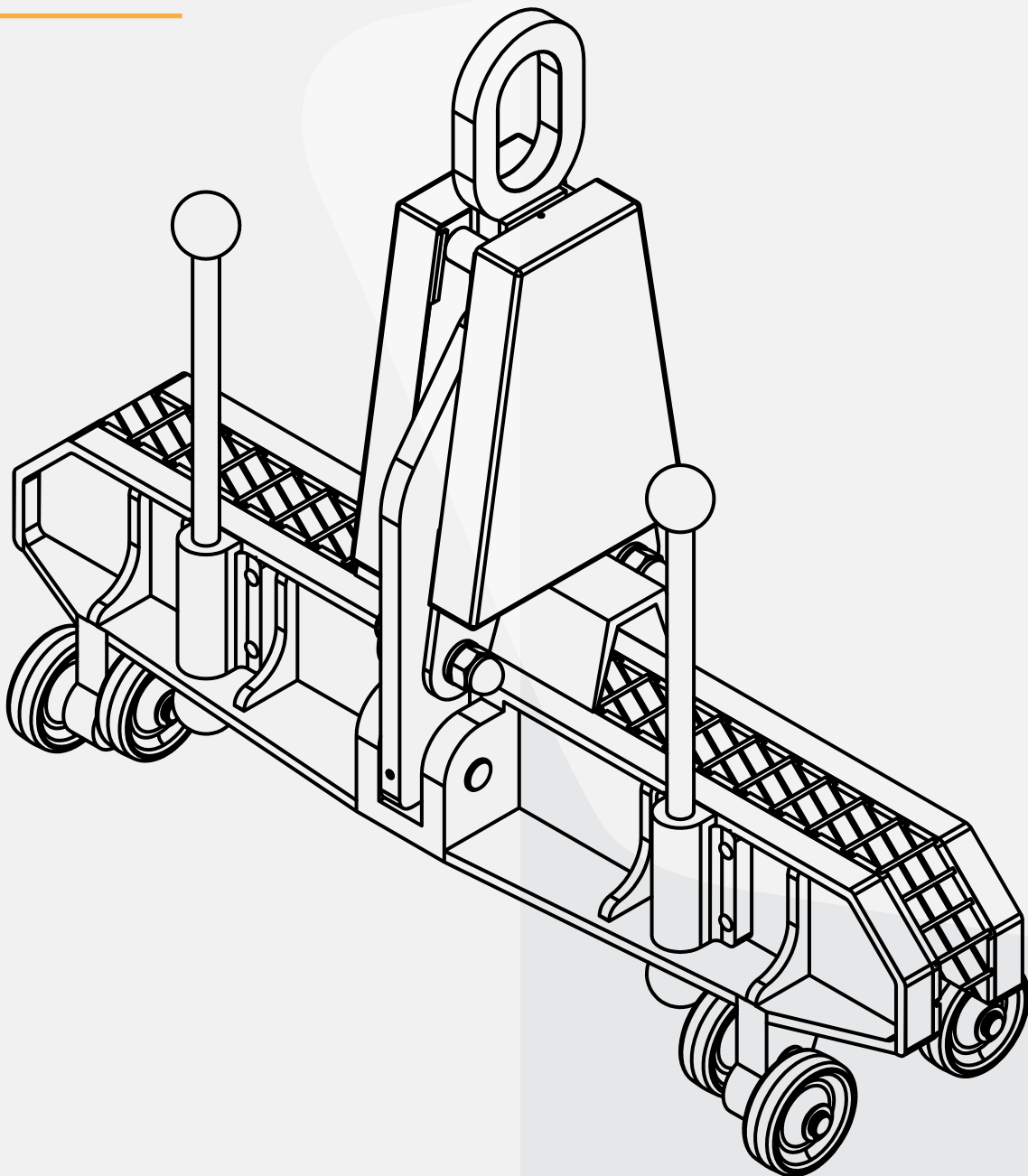

PURPOSE OF THIS MANUAL:

The purpose of this manual is to assist the operator in the correct use of the Aardwolf Glass Lifter (AGL32), to provide information on the safe use of the Glass Lifter and to eliminate any risks that might be caused by the incorrect use of the Glass Lifter.

The Aardwolf Glass Lifter must be used only for the purpose for which it has been made, namely for lifting and moving slab form loads with smooth surfaces. Any other use is to be considered improper, and consequently, dangerous. The manufacturer cannot be held responsible for any damage to people or property by improper, incorrect or unreasonable use of the machine.

This user manual should be read, trained, and understood by operators prior to use, and should form part of a broader, safe operating procedure for moving slabs utilizing the Aardwolf Glass Lifter using a forklift and/or gantry crane.

INTRODUCTION:

The Aardwolf Glass Lifter (AGL32) is a unique lifting device for glass with smooth surfaces.

This equipment incorporates a spring-loaded latch that automatically releases the lifter from the slab once the slab has been fully lowered to the ground.

The operating process becomes simple by one man user's interaction only. And it can be used in and outside the factory.

Aardwolf is always upgrading of latest technologies for this product line to make the operating process becomes easier to lift and move of glass safer and more convenient.

The Aardwolf Glass Lifter is not only providing a bigger surface of contact but also clamping force is tighter & safer.

CONTENTS:

- | | |
|-----------------------------|---------------------------------------|
| ➤ GENERAL SAFETY OPERATIONS | ➤ INSTRUCTIONS FOR USE |
| ➤ DIMENSIONS | ➤ EXAMPLE |
| ➤ DRAWING & PARTS LIST | ➤ INSPECTIONS, MAINTENANCE AND REPAIR |
| ➤ SPECIFICATIONS | ➤ WARRANTY |

The Aardwolf Glass Lifter (AGL32) is the perfect piece of equipment for lifting and moving materials in the glass industry. This equipment is integrated with automatic self-adjustment without an external electric or pneumatic engine. These durable and dependable lifters are ideal for any racking system.

GENERAL SAFETY OPERATIONS

The user's manual for the Aardwolf Glass Lifter (AGL32) must always be available at the operation site. The instructions mentioned in this manual must be strictly adhered to avoid injury.

Furthermore, supplementary to the instruction manual must enforce the statutory regulations governing general accident prevention and environmental protection.

Before starting, the operating and maintenance personnel must have read and understood the user's manual, particularly the safety instructions, before starting work. Protective equipment must be made available for operating and maintenance personnel and worn at all times. The user or his representative is responsible for supervising operating personnel and ensuring they know the hazards and safety implications of working with the Aardwolf Glass Lifter.

The user must only operate equipment on a level, clean, and in a location that will allow the user to stay in a safe position, not under or near the load on the clamp. The operator uses a place that will not be hazardous to the operator or present dangerous conditions from a place that will not be hazardous to the operator or current complex conditions.

The Aardwolf Glass Lifter is designed to reduce risks during the lifting process. Operators must adhere to the safety guidances listed below:

- Carefully consider all safety regulations and existing standards and codes in your country for hoisting operations.
- Permission to work with the Glass Lifter should only be given to people who are suitably trained, competent and acquainted with this operating manual and safety regulations.
- Inspect clamp. If the clamp is worn or damaged, do not use it.
- Select the proper size clamp for the job. Determine the weight of the glass to be lifted. Do not exceed the working load limit shown on the clamp. Glass thickness must be within the grip range specified by the manufacturer.
- Do a risk assessment of the material that is being lifted. The glass must be free of fractures and other defects that may cause the glass to fall apart while being lifted.
- All personnel must stand clear of the load while it is being lifted or moved.
- The grip depends on friction. Check that the rubber pads are free from dirt, grease & other substances that may reduce their effectiveness.
- The lifter only lifts one glass for each shift and it must be tight during the lifting process.

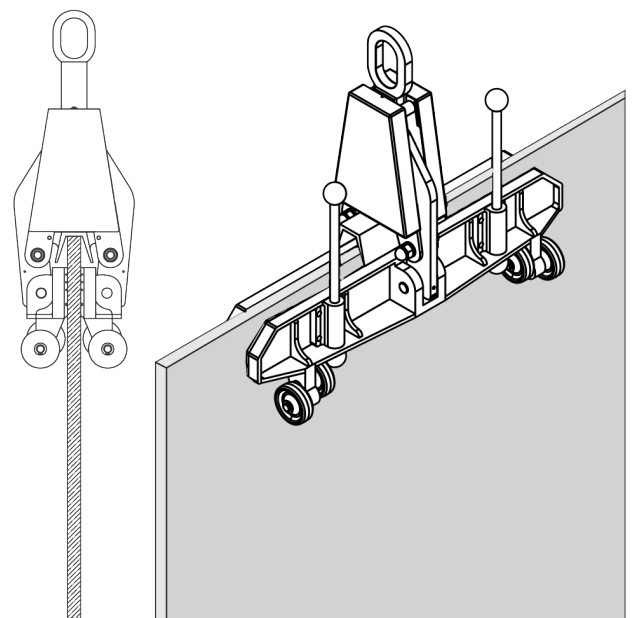

GENERAL SAFETY OPERATIONS

- Do not lift wet glass. The grip depends on friction. Lifting wet glass may cause the rubber pads to lose their grip.
- Position the clamp so that it is square with the glass to be lifted, and in the center of the glass so that the load is balanced.
- Make sure that the glass is inserted to the full depth into the opening of the clamp.
- Take up slack slowly. A trial tensioning of the load will usually indicate proper balance.
- Do not lower the clamp onto other glass or material while lowering the glass into racks, as the clamp will release its load.

Important! In order to protect people from getting injured it is important to follow some general safety directions while using hoisting accessories.

- Read the operation manual carefully before you use hoisting accessories.
- Make sure that the operation manual is always available at the place where the hoisting accessories are used.
- Give permission to work with hoisting accessories only to people who are suitably trained and competent.
- Wear safety equipment, like the helmet, gloves and safety boots.
- Never leave a lifted load unsupervised.
- Lift a load only as much as is really necessary.
- Do not get underneath the load and do not permit others to do so.
- Connections or individual parts of hoisting accessories should never be able to loosen by themselves.
- Hoisting accessories must be stored in a place where they are protected against weather conditions and aggressive substances.
- Defect hoisting accessories are no longer to be used.
- Repairs and checks are to be made only by qualified people.

DIMENSIONS

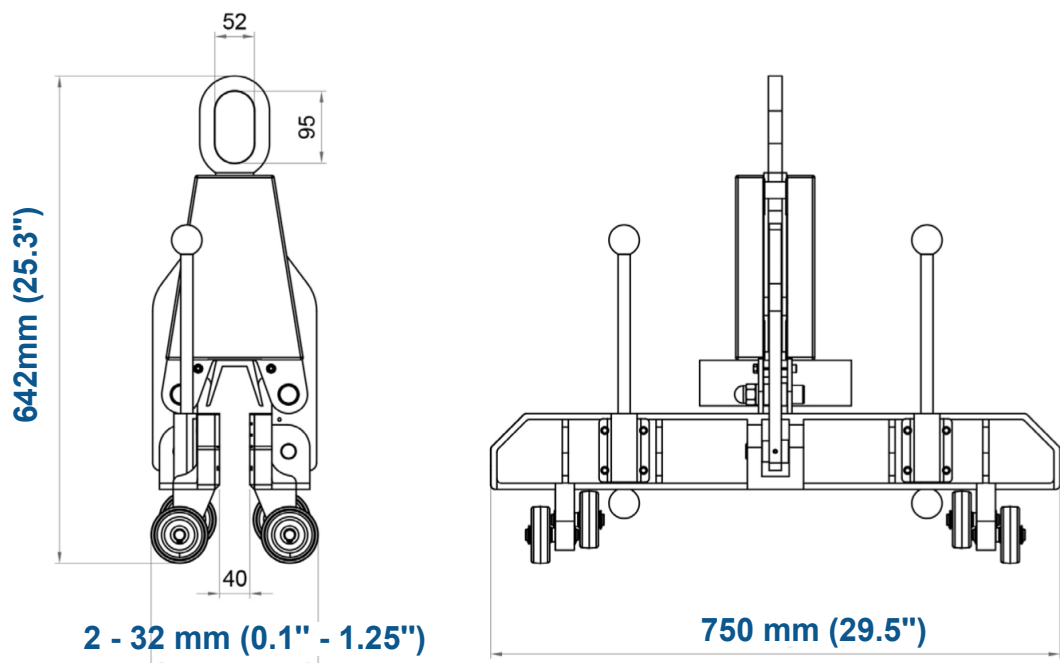

DRAWING LIST

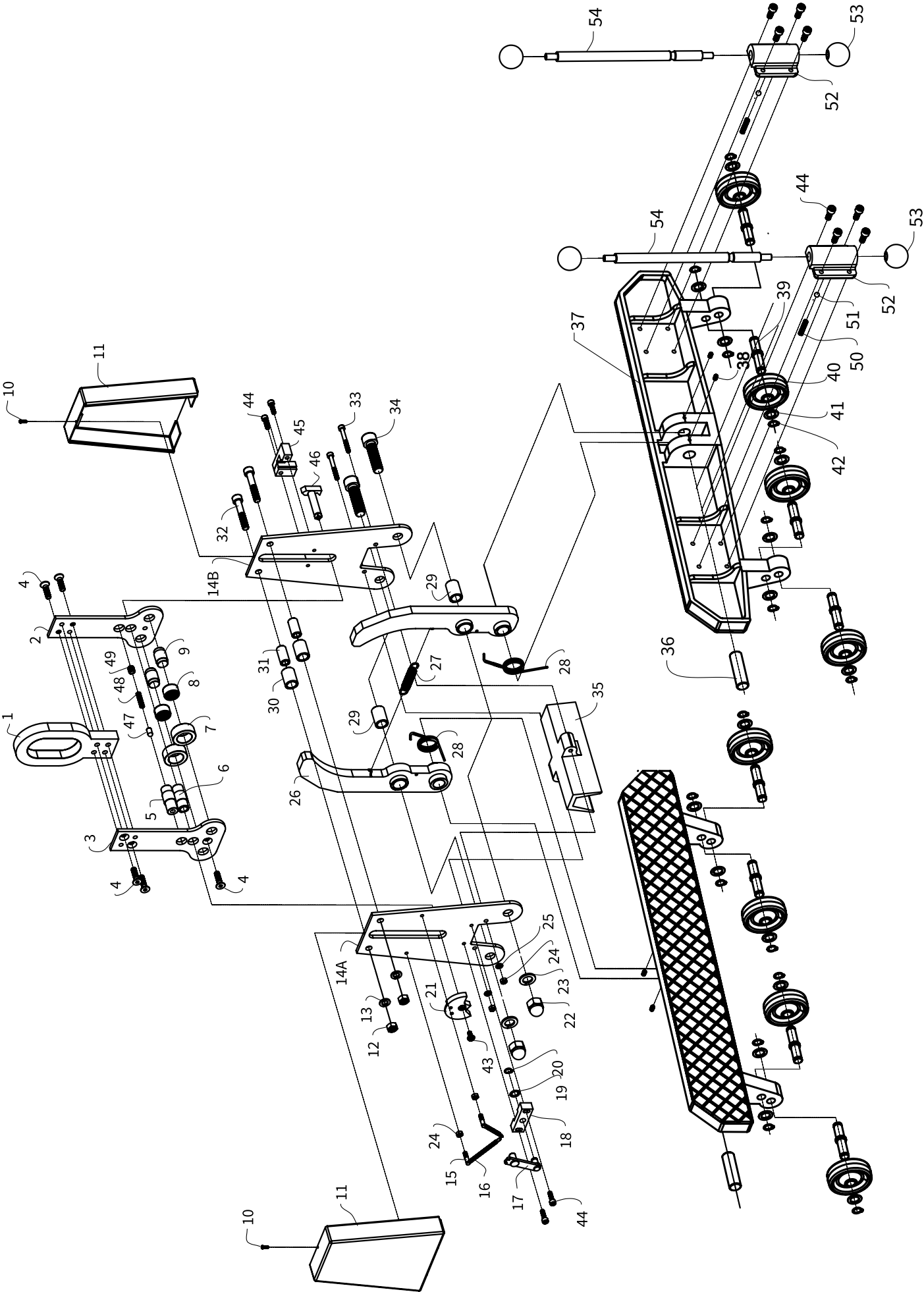

PARTS LIST

POS.	CODE	DESCRIPTION	Q'TY
1	AGL32 - 01	Lug links	01
2	AGL32 - 02	Lifting rear	01
3	AGL32 - 03	Lifting front	01
4	AGL32 - 04	Countersunk head socket screw M8 x 30	05
5	AGL32 - 05	Top pin guide (*)	01
6	AGL32 - 06	Bottom pin guide (*)	01
7	AGL32 - 07	Roller B (*)	02
8	AGL32 - 08	Roller Bearing HK2016	02
9	AGL32 - 09	Shaft B (*)	02
10	AGL32 - 10	Pan head screw M3 x 10	02
11	AGL32 - 11	Cover	02
12	AGL32 - 12	Hex. nut M10	02
13	AGL32 - 13	Spring washer Ø 10	02
14A	AGL32 - 14A	Main body front	01
14B	AGL32 - 14B	Main body rear	01
15	AGL32 - 15	Pin M6 (*)	02
16	AGL32 - 16	Extension spring Ø5.6 - 40 (*)	02
17	AGL32 - 17	Locking latch arm (*)	01
18	AGL32 - 18	Plate (*)	01
19	AGL32 - 19	Brass Washer Ø10	01
20	AGL32 - 20	Circlip Ø10	01
21	AGL32 - 21	Cam Locking latch (*)	01
22	AGL32 - 22	Hexgon domed Cap nut M16	02
23	AGL32 - 23	Spring washer Ø 16	02
24	AGL32 - 24	Hex. nut M6	02
25	AGL32 - 25	Spring washer Ø 6	02
26	AGL32- 26	Arm	02
27	AGL32 - 27	Extension spring	01
28	AGL32 - 28	Torsion spring	02
29	AGL32 - 29	Spacing B (*)	02
30	AGL32 - 30	Roller A (*)	02
31	AGL32 - 31	Spacing A (*)	02
32	AGL32 - 32	Hexagon socke head cap screw M10 x 55	02
33	AGL32 - 33	Hexagon socke head cap screw M6 x 50	02
34	AGL32 - 34	Hexagon socke head cap screw M16 x 60	02
35	AGL32 - 35	Stop guide	01
36	AGL32- 36	Jaw shaft (*)	02
37	AGL32 - 37	Jaw	02
38	AGL32 - 38	Set Screw M6 x 10	04
39	AGL32- 39	Wheel Shaft	08
40	AGL32 - 40	Wheel Ø 75	08
41	AGL32 - 41	Washer Ø 14	16
42	AGL32 - 42	Circlip Ø 14	16
43	AGL32 - 43	Recessed pan head screw M6x12	01
44	AGL32 - 44	Hexagon socke head cap screw M6 x 20	12
45	AGL32 - 45	Locking stop guide (*)	01
46	AGL32 - 46	Locking shaft (*)	01
47	AGL32 - 47	Ball pin (*)	01
48	AGL32 - 48	Compression spring (*)	01
49	AGL32 - 49	Set Screw M10 x 10	01
50	AGL32 - 50	Compression spring	02
51	AGL32 - 51	Steel ball Ø10	02
52	AGL32 - 52	Handle base	02
53	AGL32 - 53	Plastic handle	02
54	AGL32 - 54	Slide bar	02

SPECIFICATIONS

AGL32	Metric	Imperial
Grip range	2 - 32 mm	0.1 - 1.25 in
Working load limit	750 kg	1654 lb
Net weight	24.5 kg	54 lb
Gross weight	26.4 kg	58 lb
Packaging dimensions	780 x 240 x 710 mm	30.7 x 9.5 x 28 in

INSTRUCTIONS FOR USE

- Operating personnel must stand so that they always have a full view of raising/lowering movements of the lifting equipment and its load.
 - Move the top of the glass out from the pack of glasses by using a pinch bar and wedge, allowing enough room for the backplate of the clamp to pass between glass and pack of glasses. Do not move the top of the glass pass center of balance, keep the glass in an inclined position.
 - Position the clamp squarely and in the center of the glass so that the load is balanced.
 - Make sure that the glass is inserted full depth into the opening of the clamp.
 - Release the locking latch so that the jaws will lock onto the glass when the lifting cable is raised.
- Note:** The Aardwolf Glass Lifter (AGL32) is integrated an auto-lock, unlock automatic mechanism which allows the glass lifter to automatically grip the glass on pick-up and release the glass on set down easier and safer.
- Lift the glass slowly to ensure the load is balanced.
 - Warning! Before lowering the load, make sure that there are no obstructions that the load or the clamp could unintentionally rest on. In this event, the clamp can drop the load.

IMPORTANT: Carefully observe the Safety instructions supplied with the lifting clamp.

EXAMPLE

CORRECT
AND
INCORRECT
METHOD
OF
GRIPPING
GLASS

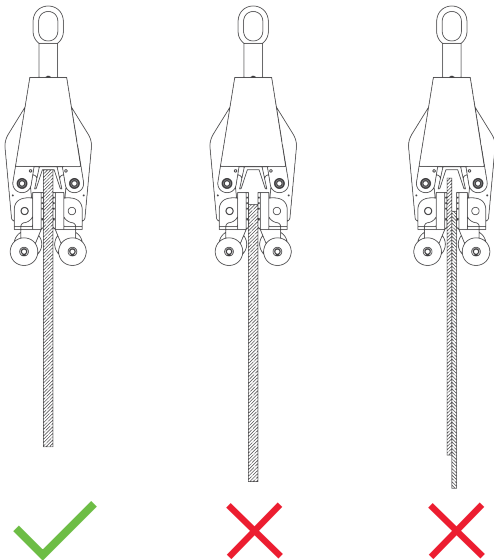

INSPECTIONS, MAINTENANCE AND REPAIR

It is important to establish a regular procedure for clamp inspection. The frequency of inspection will depend upon the amount of use the clamp receives. You may wish to maintain a written record, indicating inspection dates, condition of the clamp on each of those dates and any repairs made. Inspection records should be reviewed periodically. Always use original spare parts when carrying out repairs or maintenance.

WARRANTY

At the time of delivery it is necessary to check that the clamp has not been damaged during shipment. Any claims must be presented within eight days of the date delivery of the product. We grant you 12 months warranty on the Aardwolf Glass Lifter (AGL32), counted from the date of purchase.

The warranty coverage is not applicable if:

- The clamp is handled incorrectly during manoeuvring.
- The operator fails to comply with the instructions in this booklet.
- The clamp's maximum permissible capacity is exceeded.
- The specifications for glass thickness are not followed.
- Damages are due to inadequate maintenance and inspections.
- Damage is due to improper storage.
- Repairs were performed by the user without our permission.
- Non-original spare parts were used.



WE ARE PROVIDING

SIMPLE, REALIABLE, COST SAVING
AND **AWESOME IDEAS** FOR YOUR BUSINESS



AARDWOLF PRODUCT VIDEO
www.youtube.com/user/AardwolfGroup



FIND YOUR NEAREST AARDWOLF FACTORY SERVICE CENTRE NEAR YOU

AUSTRALIA

1/5 Stanton Road, Seven Hills NSW 2147

Tell: 02 9838 8427

Web: www.aardwolfaustralia.com **Email:** enquiries@aardwolfaustralia.com

BULGARIA Str.Usta Kolio Ficheto 33 **Tell:** +359 887 933 754

INDIA

Harama Road, Industrial Area, Madanganj, Kishangarh, District- Ajmer,
Rajasthan India 305801

Web: www.aardwolf.co.in

Tell: +91 73000 68444

Email: sales@aardwolf.co.in

GERMANY

Schulze-Delitzsch-Weg 2, 33175 Bad Lippspringe

Tell: 05252 8382830

USA

19201 South Reyes Avenue, Suite A3 Rancho Dominguez California,
90221

Web: www.aardwolfusa.com

Email: leo@aardwolfusa.com

VIETNAM

1B, An Phu, Thuan An City, Binh Duong Province, Vietnam

Tell: +84 931 707 793

Web: www.aardwolf.com.au

Email: info@aardwolf.com.au