

# SLAB BUNDLE HANDLER

**SBH02**

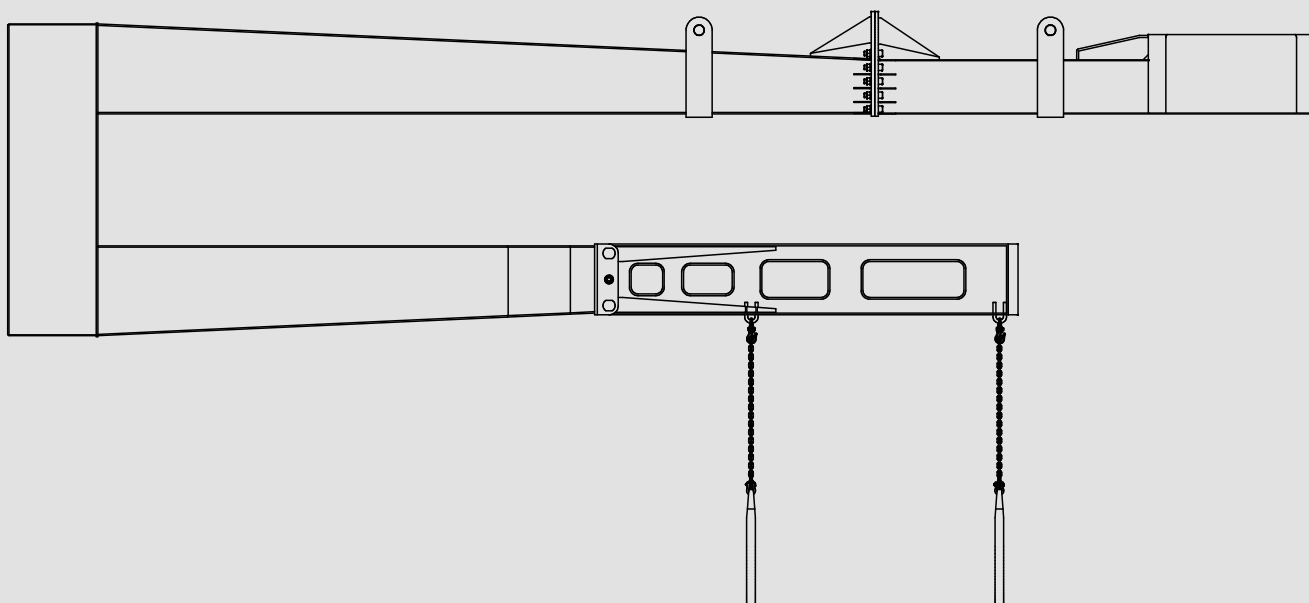

**CREATED BY**

**AARDWOLF INDUSTRIES**  
*Marketing Department*

Published on:  
**Sept 2024**

Contact us:  [info@aardwolf.com.au](mailto:info@aardwolf.com.au)  
 [www.aardwolf.com.au](http://www.aardwolf.com.au)



# INDEX

## Page

### 01 OVERVIEW

Introduction, Specifications	04
Product Overview	
Dimensions	05
Drawing	06
Parts list	07

### 02 SAFETY INSTRUCTIONS 08

### 03 ASSEMBLY 09

### 04 MAINTENANCE 09

### 05 USER INSTRUCTIONS

Attach this handler to the crane	10
Attach the stone slab to the handler	10

### 06 WARRANTY 11

**Dear Customer,**

Thank you for choosing the **Aardwolf Slab Bundle Handler - SBH02**.

Please read the manual carefully before use and keep it readily accessible beside the lifter at all times.

If you have any questions, require spare parts, or need to report any issues, please contact the Aardwolf distributor at your location, provide the product code and serial number, and send them to ***info@aardwolf.com.au*** for assistance.

We hope this advanced tool meets your needs and exceeds your expectations.

Best regards,

**Aardwolf Industries**

 [info@aardwolf.com.au](mailto:info@aardwolf.com.au)

 [www.aardwolf.com.au](http://www.aardwolf.com.au)

# 01 OVERVIEW



## INTRODUCTION

As a crate extraction unit, the Slab Bundle Handler is a crane attachment used for lifting crated marble and granite slabs from closed-top containers. Designed to lift stone slab bundles securely and to increase efficiency and worker safety with improved load handling. With the addition of a Slab Bundle Handler, your existing crane can be used to perform many of the functions generally associated with a forklift truck. It is used most efficiently on gantry cranes with a 5-ton capacity or greater. The Slab Bundle Handler can also be used on mobile cranes.



## SPECIFICATIONS

### Slab Bundle Handler - SBH02

Working load limit	5000 kg / 11023 lb
Net weight	3200 kg / 7055 lb
Gross weight	3210 kg / 7077 lb
Packaging dimensions	L.5780 x W.630 x H.1600 mm (A) 227.5 x 24.8 x 62.9 in L.2530 x W.610 x H.600 mm (B) 99.6 x 24 x 23.6 in



## PRODUCT OVERVIEW

### DIMENSIONS

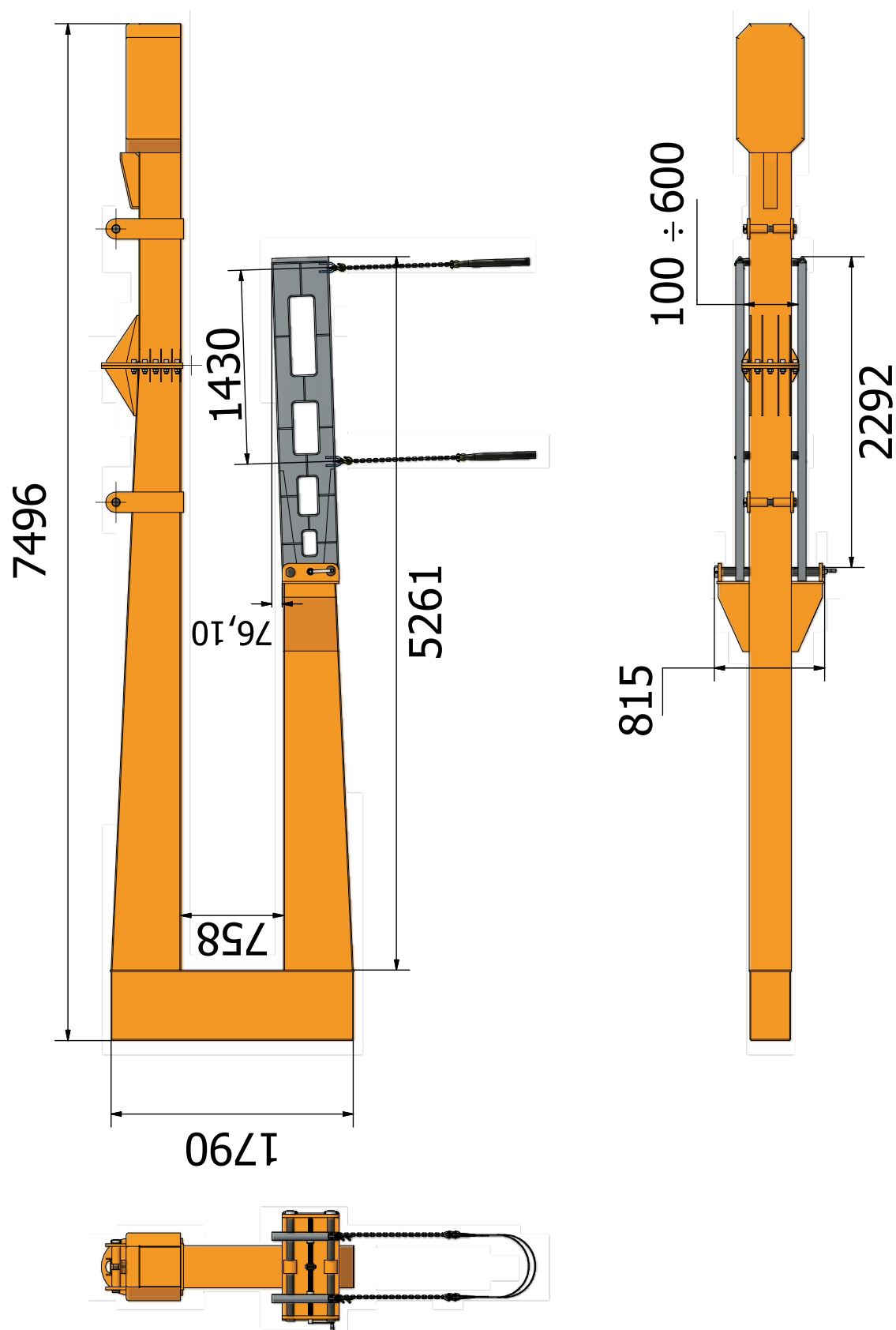



## PRODUCT OVERVIEW

### DRAWING - SBH02

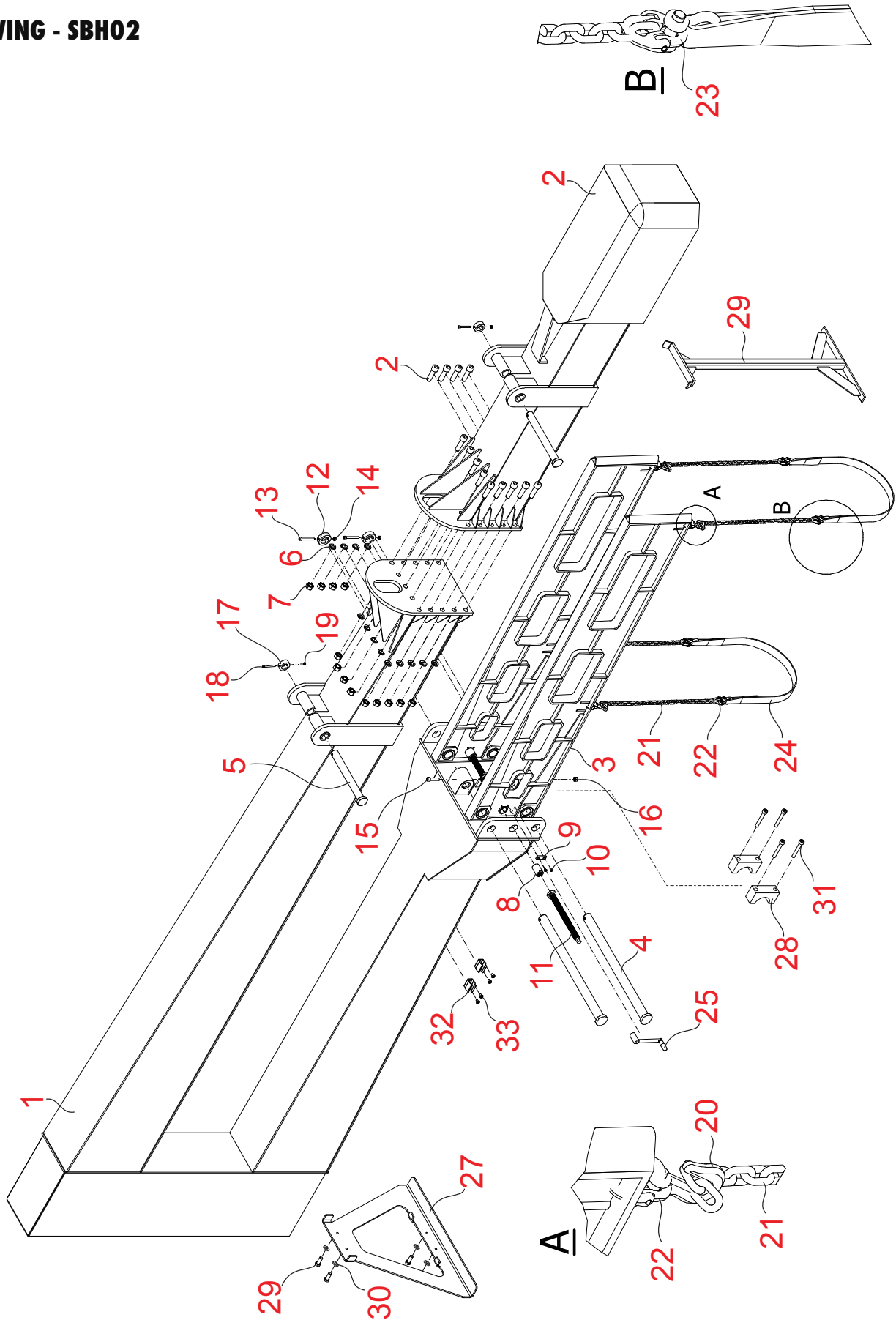



## PRODUCT OVERVIEW

### PARTS LIST - SLAB BUNDLE HANDLER

POS.	DESCRIPTION	Q'TY
1	Beam	1
2	Counter Weight	1
3	Adjustable Load Bearing Arm	2
4	Pin 50	2
5	Pin 40	2
6	Spring Washer M24	13
7	Nut M24	13
8	Nut Visme	2
9	Located Plate	2
10	Countersunk Bolt M8x16	4
11	Lead Screw	2
12	Collar D50	2
13	Hexagon Socket Head Bolts M10x90	2
14	Nut M10	2
15	False Key M14x65	1
16	Nut M14	1
17	Collar D40	2
18	Hexagon Socket Head Bolts M8x70	2
19	Nut M8	2
20	Grab Hook	4
21	Chain Line	4
22	Coupling Link - Type G	8
23	Bow Shackle 1.5 Ton	4
24	Sling	2
25	Crank 19	1
26	Hexagon Socket Head Bolts M24x80	13
27	Back Leg	1
28	Shaft Cover	2
29	Hexagon Head Bolts M14x40	4
30	Washers Ø14	4
31	Hexagon Socket Head Bolts M6x40	4
32	Handle Bracket	2
33	Hexagon Socket Head Bolts M6X16	4

# 02 SAFETY INSTRUCTIONS



## GENERAL

- Carefully observe all existing safety regulations and standards in your country for hoisting operations.
- The operation must be taken by an authorized and competent person who is well trained and acquainted with the manual and safety regulations of hosting operations.
- Well inspect the handler. If any parts are worn or damaged, do not use.
- Determine the weight of load. Do not exceed W.L.L of the handler as specified by the manufacturer.
- Do a risk assessment of material that is being lifted.
- All personnel must stand clear of the load as it is being lifted or transported.
- A lift trial is strongly recommended. It should be slowly lifted to ensure its balance.
- Make sure that the manual is always available at the place where the hoisting attachments are used.
- Read the manual attentively prior to operation.
- Ensure the operator's manual is available and understood by all operators.
- Wear proper safety clothing.
- It is important to ensure that regular examinations and inspections of lifting gear are undertaken to ensure maintenance is kept, and to verify that the equipment can continue to be safely used.
- Lifting gear inspections must be undertaken on a regular basis, by a person with adequate training, knowledge, skills and expertise.



## 03 ASSEMBLY

- Carefully check each spare part prior to assembly so that all spare parts are ensured to be brand-new. If any defect items are found, contact the manufacturer at the soonest time.
- There is always a part drawing in front of your eyes as assembly.
- Strictly comply with your country's assembly regulations and standards if any.
- Before attaching this handler to the crane, carefully check each items are correctly, securely and safely assembled.

## 04 MAINTENANCE

The procedures of maintenance and repair should be established as mandatory regulations and policies. They vary depending on the amount and purpose of use, the buyer's own policy. As normal, it should include the frequency of inspection, the policy of defects found and repair and the policy of record filing.



# 05

## USER INSTRUCTIONS



### ATTACH THIS HANDLER TO THE CRANE

- ↘ The operators in charge of operating this handler should be welltrained, competent and ensured to carefully learn the manuals prior to operation.
- ↘ Carefully inspect the handler. If there are damages found, do not use.
- ↘ Do not forget the W.L.L of handler and do not exceed it.
- ↘ Move the handler to the stone slab site via the truck. It is possible to position the handler in a balanced and stable manner with a supporting bar.
- ↘ Joint the handler ring to the crane hook so as to ensure that the joint is firmly connected.
- ↘ Remove the supporting bar after jointing the handler and the crane.
- ↘ Lightly lift the handler up to the expected height. Ensure that no one is standing under the load to avoid accidents.



### ATTACH THE STONE SLAB TO THE HANDLER

- ↘ This handler is equipped with the alloy steel chain allowing the operators to flexibly adjust the length of chain. The alloy steel chain is jointed to the nylon made sling to cover the slab.
- ↘ Lightly cover the slab by the sling in a surely firm way.
- ↘ The handler is armed with the load bearing arm which is easily adjustable via a wind handle. The wind handle is put into the hexagon end of the lead crew to easily adjust both two arms in the same direction. The opening range of arms is within 100 – 600 mm for the handler 5T (Tolerance +10 mm) .
- ↘ In event that the operator would like to adjust one arm – left or right – a false key (part 16 for the handler 3T or part 15 for the handler 5T) must be released out of stop end screw (part 15 the 4 handler 3T or part 16 for the handler 5T).
- ↘ Lightly lower down and adjust the width of arms so as to securely and totally embrace the slab.
- ↘ Carefully and diligently check the position of gravity center of slab to prevent the slab from sliding. It is a strongly grave step to avoid regrettable accidents.
- ↘ Lightly move the slab to the expected place. Once again, ensure that no one is right under the load to avoid accidents.

# 06 WARRANTY



## PRODUCT CHECK AND REPORTING

Upon receiving the product, the buyer should verify, based on the spare parts list and attached spare drawings, that all spare parts are intact and not lost during shipment. Any damages or losses must be officially reported to Aardwolf Industries within eight days of purchase.



## WARRANTY INFORMATION

The Slab Bundle Handler comes with a 12-month warranty from the date of purchase, following Aardwolf Industries warranty policy.



## WARRANTY EXCLUSIONS

The warranty coverage does not apply if:

- ↘ The product is handled incorrectly during maneuvering.
- ↘ The user fails to comply with the instructions provided in the manual.
- ↘ The Lifter's maximum W.L.L is exceeded.
- ↘ The specifications for the load thickness are not followed.
- ↘ Damages result from inadequate maintenance and inspections.
- ↘ Damage is due to improper storage.
- ↘ Repairs are performed by the user without permission from Aardwolf Industries.
- ↘ Unofficial spare parts are used.



## DECLARATION OF CONFORMITY

We declare that the Aardwolf Slab Bundle Handler conforms to the following standards:

- ↘ The Machinery Directive 2006/42/EC
- ↘ Australian Standard 4991-2004

**Note:** It is the user's responsibility to comply with state or local laws. The end user is responsible for using the equipment safely, in the manner it is designed for, and within the unit's rated capacity.

## WE PROVIDE

Simple, Reliable, Cost Saving And  
Awesome Ideas For Your Business

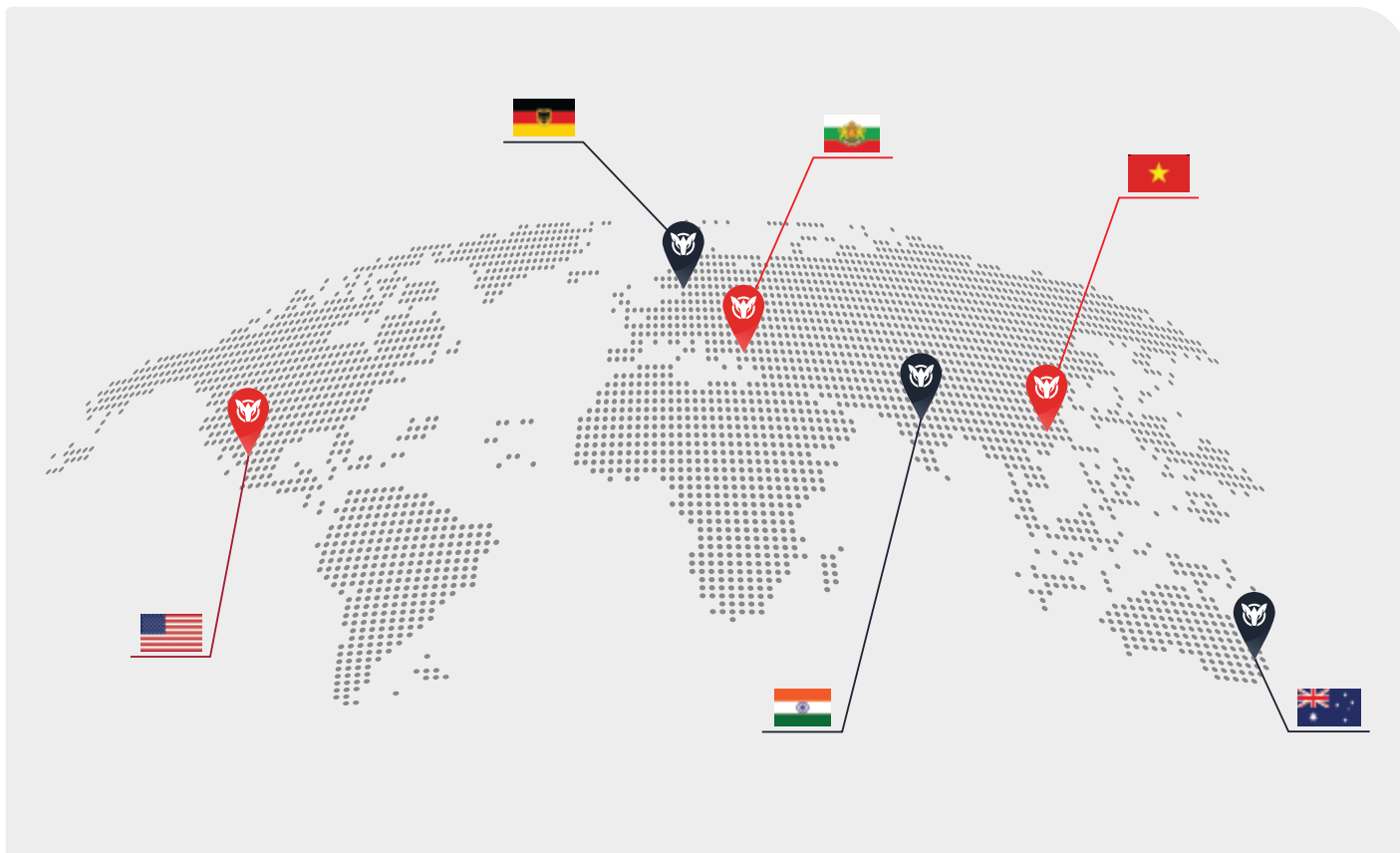

## FIND THE NEAREST AARDWOLF SERVICE CENTER

### AUSTRALIA

1/5 Stanton Road, Seven Hills NSW 2147  
Tel: 02 9838 8427  
Email: [enquiries@aardwolfaustralia.com](mailto:enquiries@aardwolfaustralia.com)  
Web: [www.aardwolfaustralia.com](http://www.aardwolfaustralia.com)

### BULGARIA

Str.Usta Kolio Ficheto 33  
Tel: +359 887 933 754  
Email: [adrian@toolrange.com](mailto:adrian@toolrange.com)

### GERMANY

Schulze-Delitzsch-Weg 2, 33175 Bad Lippspringe  
Tel: 05252 8382830  
Email: [sales@aardwolf.com.de](mailto:sales@aardwolf.com.de)

### INDIA

Harmara Road, Industrial Area, Madanganj, Kishangarh,  
District- Ajmer, Rajasthan India 305801  
Tel: +91 73000 68444  
Email: [sales@aardwolf.co.in](mailto:sales@aardwolf.co.in)  
Web: [www.aardwolf.co.in](http://www.aardwolf.co.in)

### USA

9401 Norwalk Blvd, Santa Fe Springs, CA 90760  
Tel: (562) 553-6050  
Email: [sales@aardwolfusa.com](mailto:sales@aardwolfusa.com)  
Web: [www.aardwolfusa.com](http://www.aardwolfusa.com)

### VIETNAM

1B, An Phu, Thuan An City, Binh Duong Province, Vietnam  
Tel: +84 931 707 793  
Email: [infot@aardwolf.com.au](mailto:infot@aardwolf.com.au)  
Web: [www.aardwolf.com.au](http://www.aardwolf.com.au)

