



# AARDWOLF LIFTING CLAMP FOR ROUND BAR 305

**OWNER'S MANUAL**

**PRODUCT CODE: BL305**



## **CONTENTS**

- SPECIFICATIONS** ▶ **FEATURES** ▶ **SAFETY INSTRUCTIONS FOR THE CLAMP**
- SAFETY INSTRUCTIONS FOR HOISTING ACCESSORIES** ▶ **PARTS DRAWING & PART LIST**
- INSTRUCTIONS FOR USE** ▶ **INSPECTIONS, MAINTENANCE & REPAIR** ▶ **WARRANTY**

The Lifting Clamp for Round Bar 305 (BL305) is designed for clamping and lifting steel pipes and steel tubes. It is fast, efficient, flexible, and fully automatic, the BL305 is ideal for work in the factory or on construction sites. It is equipped with an auto-locking latch mechanism, and it needs no electric or hydraulic power supply. The BL305 can be used with overhead crane or forklift boom to pick and place materials.



## 1. TECHNICAL SPECIFICATIONS

	<b>Metric</b> (mm-kg)	<b>Imperial</b> (inch-lb)
Grip range	200 - 305	8" – 12"
Working load limit	320	706
Net weight	26	57
Gross weight	29	64
Packaging dimensions	740 x 245 x 580	29.1" x 9.6" x 22.8"

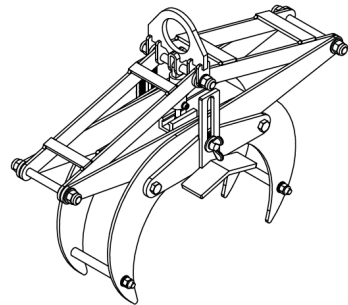
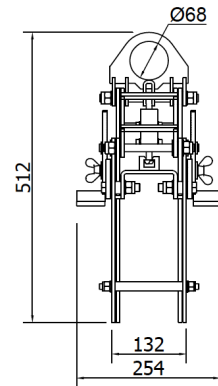
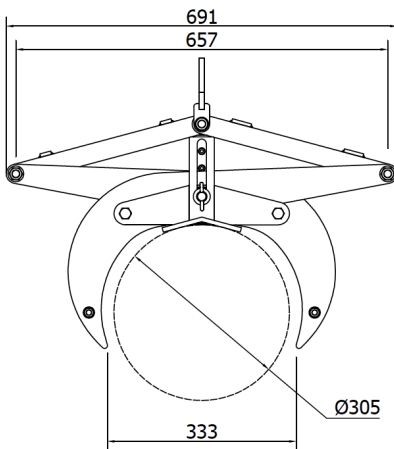

## 2. FEATURES

- Handling long steel pipes and tubes, especially for steel pipe assembly system.
- Made from durable steel material.
- Sturdy and safe construction.



- Carefully consider all safety regulations and existing standards and codes in your country for hoisting operations.
- Permission to work with the Lifting Clamp For Round Bar should only be given to people who are suitably trained, competent and acquainted with this operating manual and safety regulations.
- Inspect clamp. If the clamp is worn or damaged, do not use it.
- Determine the weight of the pipe or tube to be lifted. Do not exceed the working load limit shown on the clamp. Pipe/tube diameter must be within the grip range specified by the manufacture.
- Do a risk assessment of the material that is being lifted.
- The pipe/tube must be free of fractures and other defects that may cause the pipe/tube to fall apart while being lifted.  
All personnel must stand clear of the load while it is being lifted or moved.
- Do not lift a wet pipe/tube.
- Only one load can be lifted at a time.
- Position the clamp so that it is square with the pipe/tube to be lifted, and in the center of the pipe/tube so that the load is balanced.
- Make sure that the pipe/tube is inserted to the full depth into the jaws of the clamp.
- Take up a pipe/tube slowly. A trial tensioning of the load will usually indicate proper balance.

**Important!** In order to protect people from getting injured, it is important to follow some general safety directions while using hoisting accessories.

- Read the operation manual carefully before you use hoisting accessories.
- Make sure that the operation manual is always available at the place where the hoisting accessories are used.
- Give permission to work with hoisting accessories only to people who are suitably trained and competent.
- Wear safety equipment, like a helmet, gloves, and safety boots.
- Never leave a lifted load unsupervised.
- Lift a load only as much as is really necessary.
- Do not get underneath the load and do not permit others to do so.
- Connections or individual parts of hoisting accessories should never be able to loosen by themselves.
- Hoisting accessories must be stored in a place where they are protected against weather conditions and aggressive substances.
- Defect hoisting accessories are no longer to be used.
- Repairs and checks are to be made only by qualified people.





## 6. INSTRUCTIONS FOR USE

- Operating personnel must stand so that they always have a full view of raising/lowering movements of the lifting equipment and its load.
- Move the clamp to the pipe/tube to be lifted and place the clamp in the center of the material so that the load is balanced.
- Make sure that the pipe/tube is inserted full depth into the jaws of the clamp.
- Adjust the gripping diameter range of the clamp so that it is suitable for the size of the pipe/tube by loosening the wing bolt is located on the center stay and then move it to the desired position within the diameter 200 to 305mm. After that screw the wing bolt tightly for ready to lift the load.
- When the clamp is lifted by a crane, the locking latch will open and the jaws will close and grip the load tightly.
- Lift the load slowly to ensure the load is balanced to the desired location.
- Warning! Before lowering the load, make sure that there are no obstructions that the load or the clamp could unintentionally rest on. In this event the clamp can drop the load.
- **Important:** Carefully observe the Safety instructions supplied with the lifting clamp.

## 7. INSPECTION, MAINTENANCE & REPAIR

There are two types of inspections - in-service and periodic.

### **In-service:**

Visual inspection before each use. This implies that before each lift, the user has a good look over the lifting clamp to ensure that there is no significant damage or wear and that the working load limit tag or markings are fitted and limit legible. At this point, if any defects are noted, the lifting clamp should be withdrawn from service, and inspected by a competent person who can make a decision on whether to use, repair, or discard the lifting clamp.



### Periodic:

The lifting clamps should be checked and tested every 12 months by a competent person who has been trained and who can make a decision on whether to use, repair or discard the lifting clamp. These inspections also need to be adequately documented and are mandatory in many countries. Always use original spare parts when carrying out repairs or maintenance.

### CE - DECLARATION OF CONFORMITY

We declare that the product is in conformity with the following standard:  
The Machinery Directive 2006/42/EC.

**Note:** It is the responsibility of the user to adapt to state or local laws. The end-user is responsible to use the equipment safely in a manner that it is designed for and within the rated capacity of the unit.

## 8. WARRANTY

At the time of delivery, it is necessary to check that the clamp has not been damaged during shipment. Any claims must be presented within 8 days of the date of delivery of the product.

We grant you 12 months warranty on the Aardwolf Lifting Clamp For Round Bar 305 countered from the day of purchase.

The warranty coverage is not applicable:

- The clamp is handled incorrectly during maneuvering.
- The operator fails to comply with the instructions in this booklet.
- The clamp's maximum permissible capacity is exceeded.
- The specifications and diameter for pipe/tube are not followed.
- Damages are due to inadequate maintenance and inspections.
- Damage is due to improper storage.
- Repairs were performed by the user without our permission.
- Non-original spare parts were used.



## VIETNAM

### AARDWOLF VIETNAM

- 📍 1B, An Phu, Thuan An, Binh Duong, Vietnam.
- ☎ +84 274 371 2827438/39
- ✉ sales@aardwolf.com.vn
- 🌐 www.aardwolf.com.vn

## AUSTRALIA

### AARDWOLF AUSTRALIA

- 📍 Unit 1, 5 Stanton Road, Seven Hills NSW 2147 Australia.
- ☎ +0422 916 907
- ✉ enquiries@aardwolfaustralia.com
- 🌐 www.aardwolfaustralia.com

## GERMANY

### STONE GLASS EQUIPMENT UG

- 📍 Am Gutsteich 11, 08451 Crimmitschau/ Blankenhain, Germany.
- ☎ +49 366 0821 9236
- ✉ sales@aardwolf.com.de
- 🌐 www.aardwolf.com.de

## INDIA

### AARDWOLF KISHANGARH

- 📍 Harmara Road, Industrial Area, Madanganj, Kishangarh, Rajasthan India / Pin no. 305801
- ☎ Tel: +91 93584 48474
- ✉ sales@aardwolf.co.in
- 🌐 Web: www.aardwolf.co.in

### AARDWOLF BENGALURU

- 📍 No: 6, Sharma Complex, 3rd Cross, Ganesha Block, Dinnur Main Road, R. T. Nagar P.O Bengaluru-560032
- ☎ +91 98451 62959/ 91 99017 24600
- ✉ bengaluru@aardwolf.co.in
- 🌐 www.aardwolf.co.in

### AARDWOLF MUMBAI

- ☎ +91 97659 06007
- ✉ mumbai@aardwolf.co.in
- 🌐 www.aardwolf.co.in

